

GB**Electrical system for trailer hitch** Installation and Operating Instructions**321 454 300 143****VW T5 GP / T6 (RHD) van, bus, 10/2009 – 09/2019**
VW T5 GP / T6 (RHD) pickup, 10/2009 – 09/2019

GB

Read the installation instructions before starting work. The electrical system for the towbar may only be fitted by qualified personnel. No warranty is given for any technical modifications and/or software updates carried out e.g. by the vehicle manufacturer after initial commissioning that cause malfunctions. Any specific requirements made by the vehicle manufacturer in respect of using a trailer must be complied with. We accept no liability for any damage or loss caused by the installation or the incorrect fitting or use of the product.

Subject to change without notice.

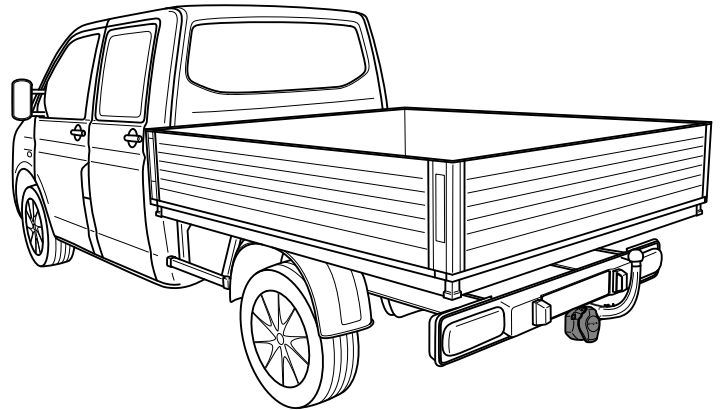
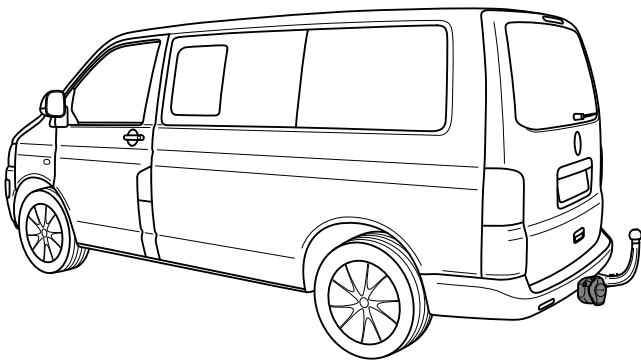
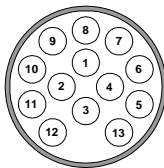
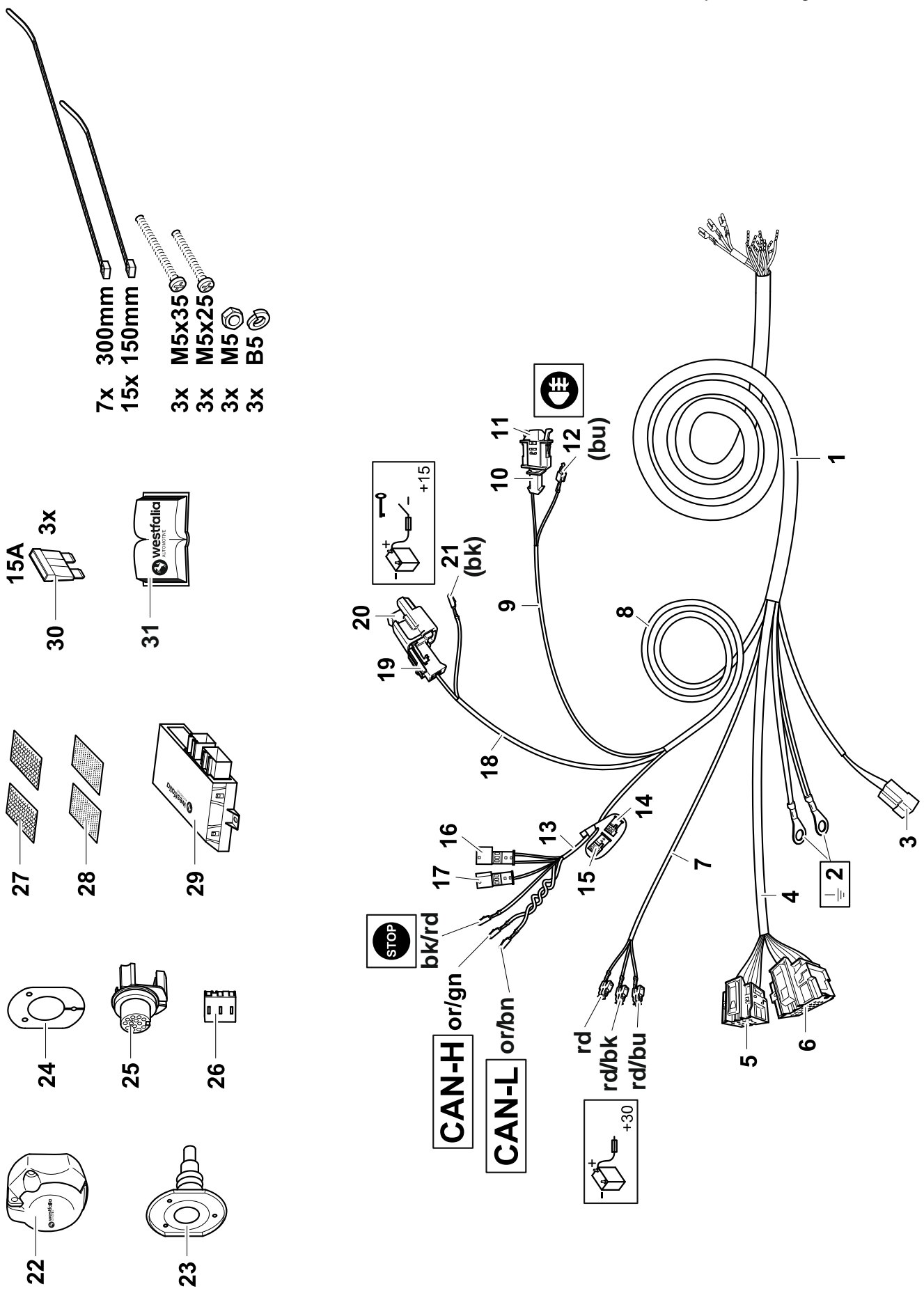

- 7x 300mm
- 15x 150mm
- 3x M5x35
- 3x M5x25
- 3x M5
- 3x B5

- 15A 3x
- 30
- 31
- 27
- 28
- 29
- 24
- 25
- 26
- 22
- 23

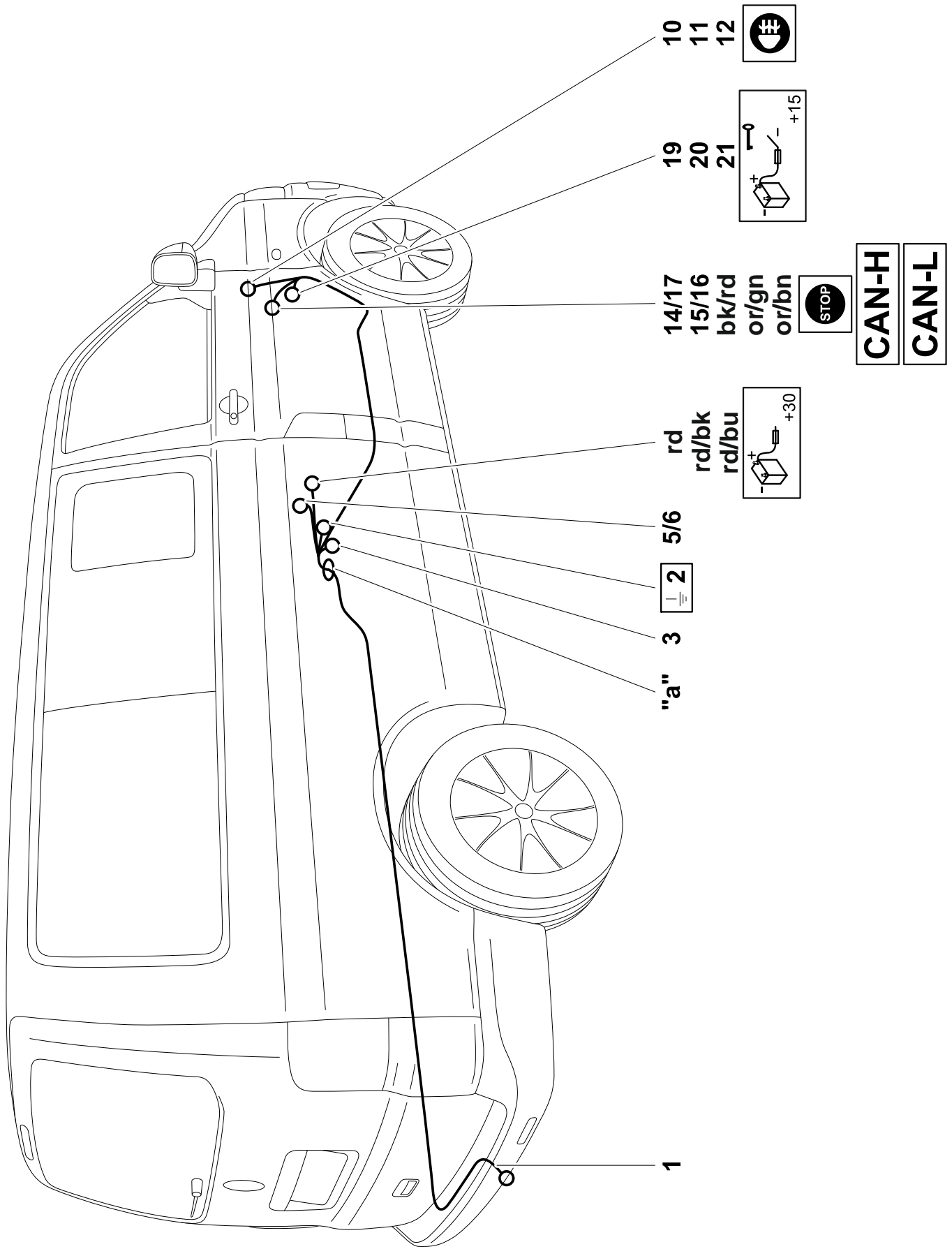

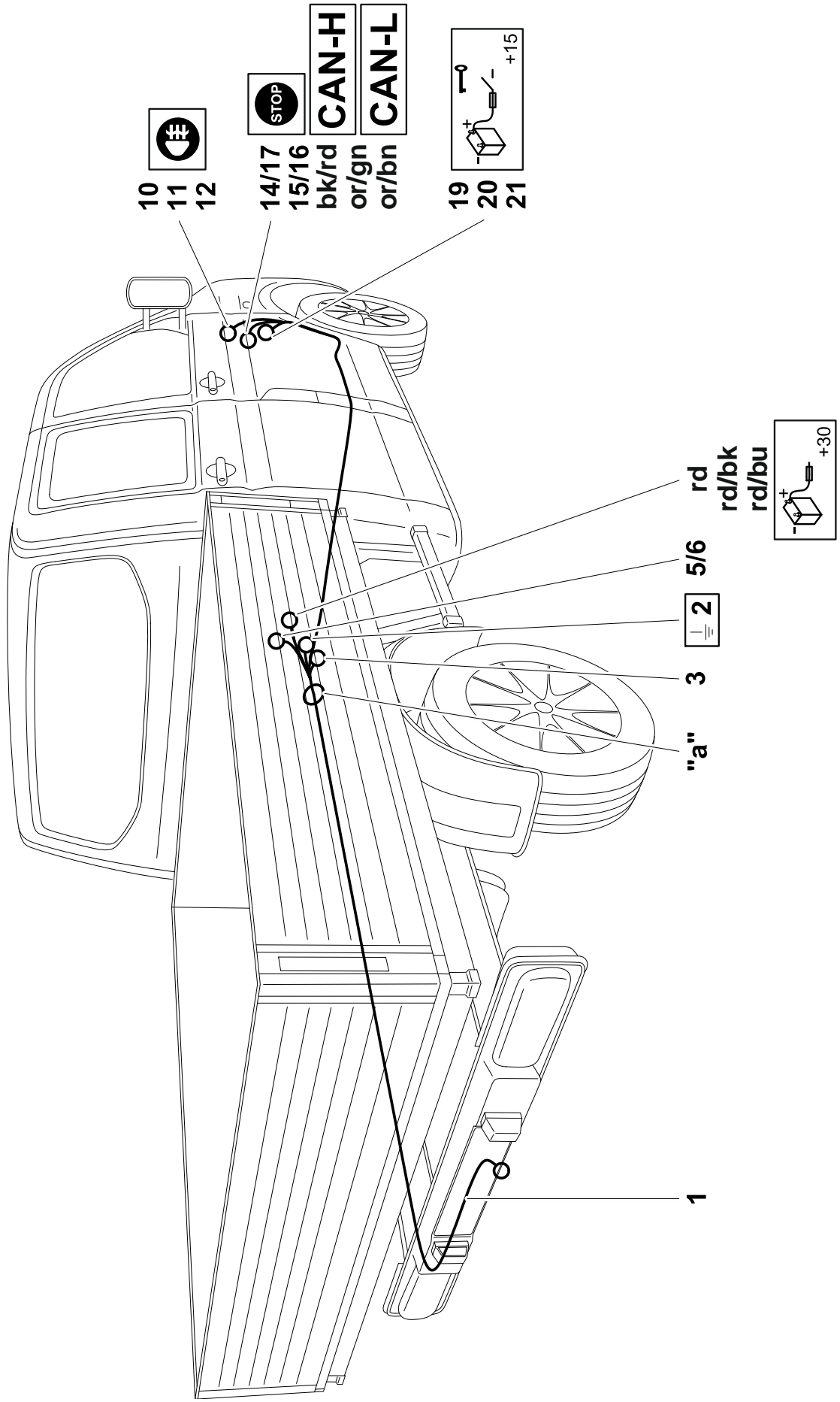

	dark	light	bk	wh	bn	gn	gy	rd	ye	bu	or	pu	pi
GB	dark	light	black	white	brown	green	grey	red	yellow	blue	orange	purple	pink

GB Pin assignment

ISO 11446

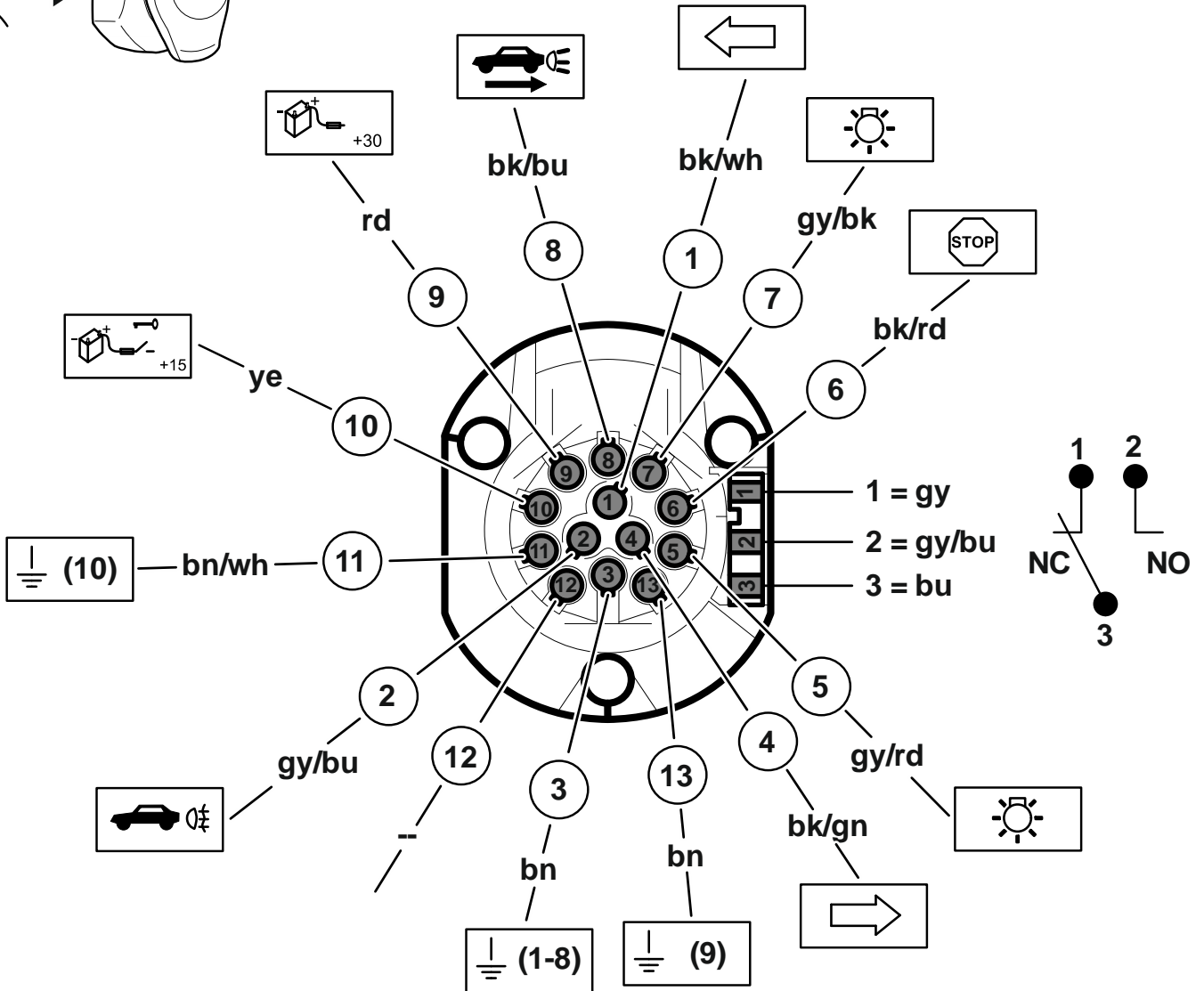
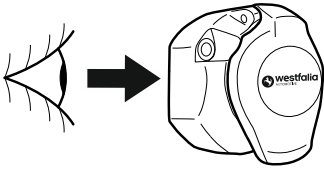

GB	left-hand indicator	
	right-hand indicator	
	rear fog lamp switch	
	rear fog lamp switched off	
	parking light left and right	
	brake lights	
	reversing lights	
	charging cable (active with ignition switched on)	
	permanent positive cable	
	ground connection	
	switch in vehicle	
	rear vehicle lights	
	Warning! high temperature	
	control module trailer towbar	

GB	no lubrication	
	LED test lamp	
	right-hand drive vehicle	
	left-hand drive vehicle	
	with parking aid	
	without parking aid	
	data bus cable (CAN)	CAN-bus xxxxxx
	CAN high signal	CAN-H xxx-H
	CAN low signal	CAN-L xxx-L
	drill and seal bodywork hole	
	adhesive tape	
	observe radio coding	
	Warning! acid	

GB	cigarette lighter, 12V socket	
	vehicle test / programming equipment	
	measure / compare function cable colour	
	note different cable colours	
	remove remote key / chipcard to 10m away from the vehicle	
	switch available in vehicle yes / no	
	connect	
	disconnect	
	signal transmitter	
	observe / recognize	
	trailer signal recognized	

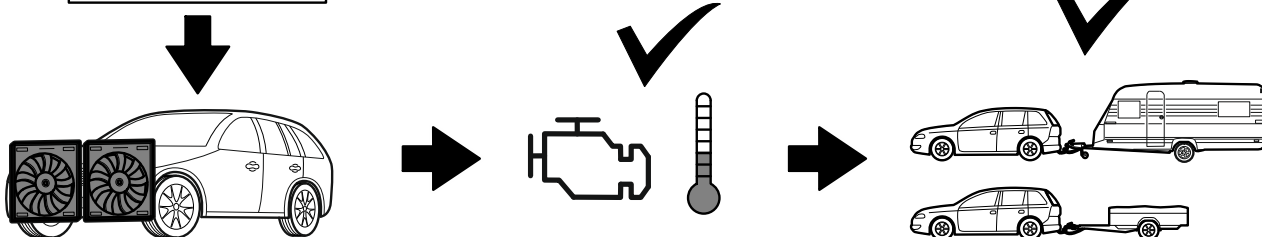
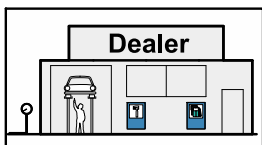
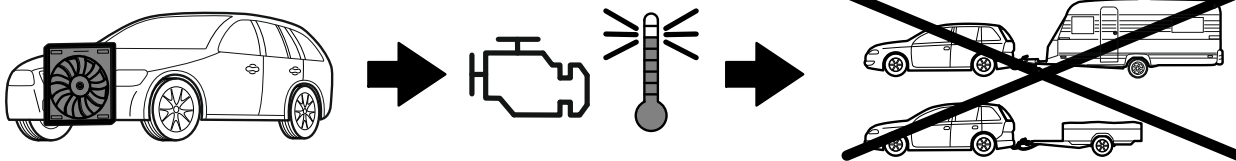
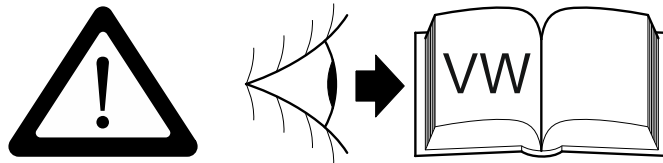

GB ! Warning ! It must be ensured that all the requirements of the vehicle manufacturer for changes to and retro-fitting on the vehicle and / or cooling system for the operation with a trailer are carried out.

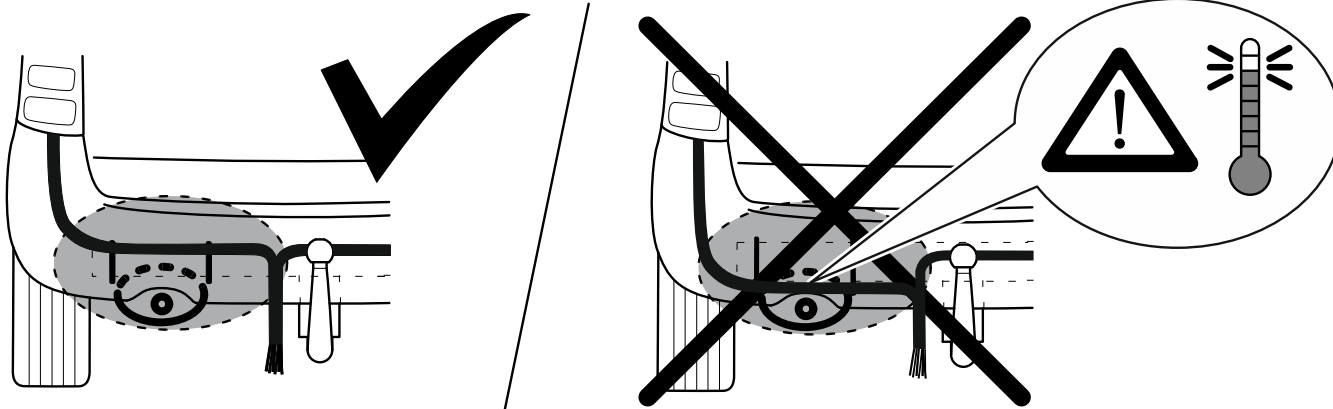

see page 26

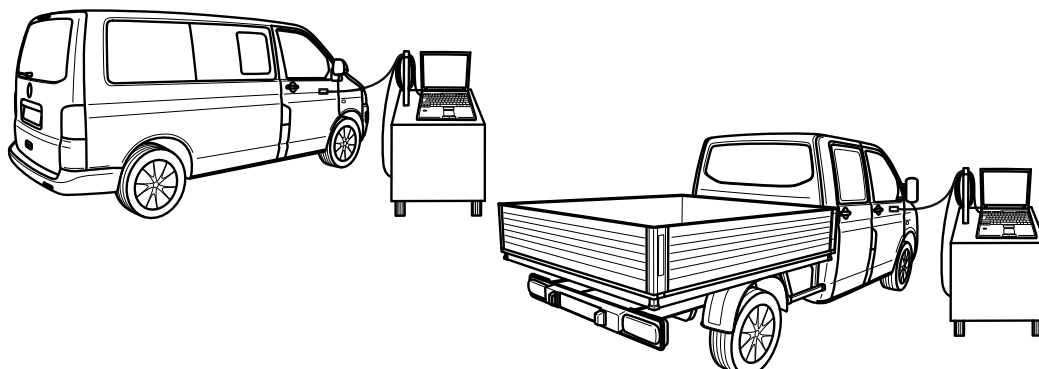

1

GB Attention – before starting to work, read out the errors stored in the memory. Disconnect the battery to prevent damage to the vehicle electronics.

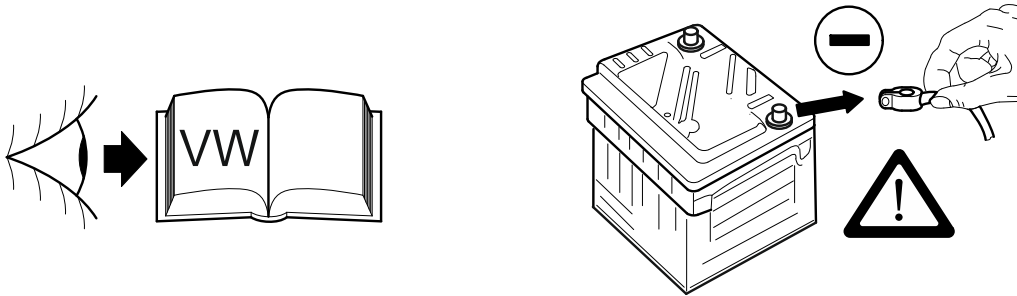

2

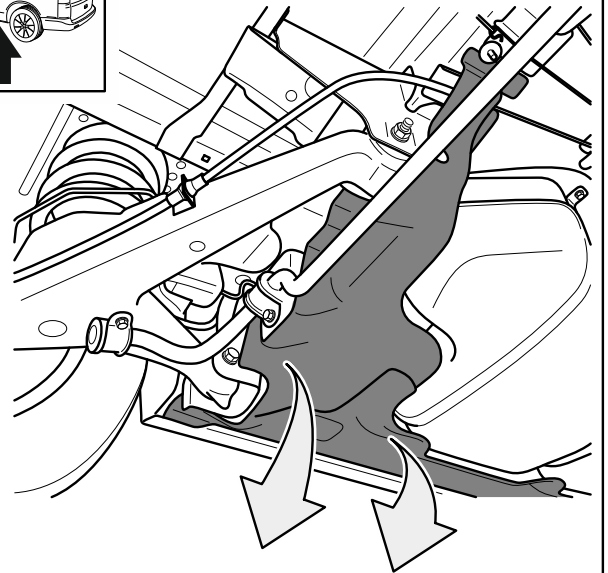
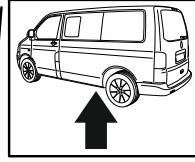
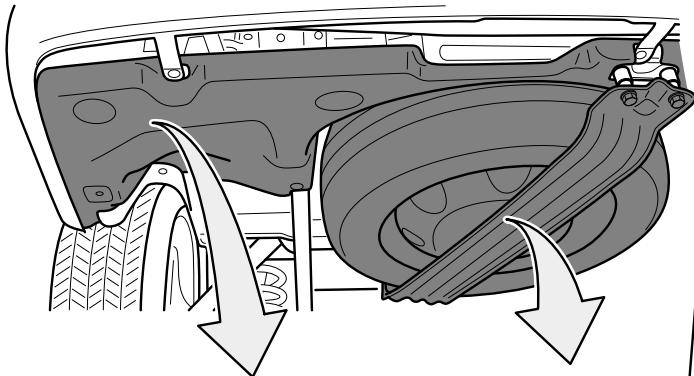
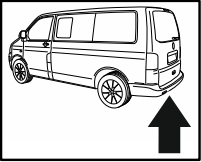

3

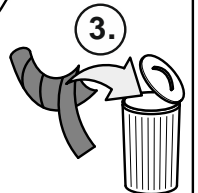
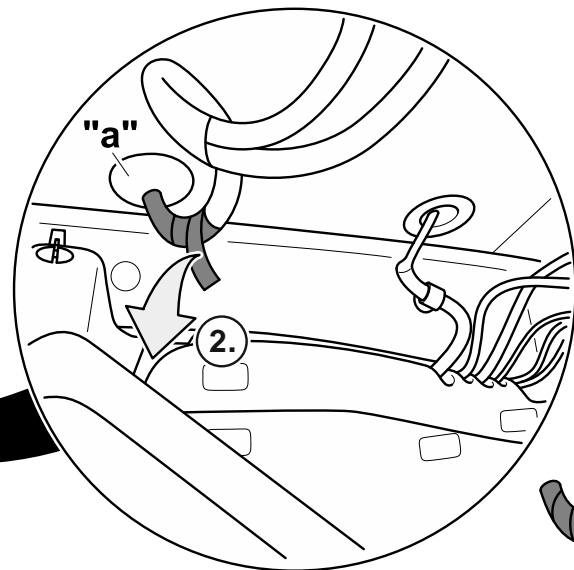
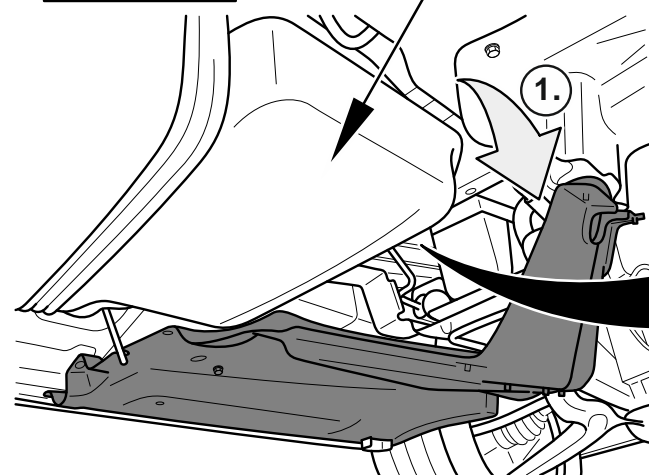
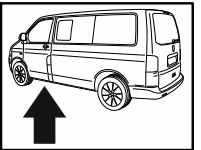

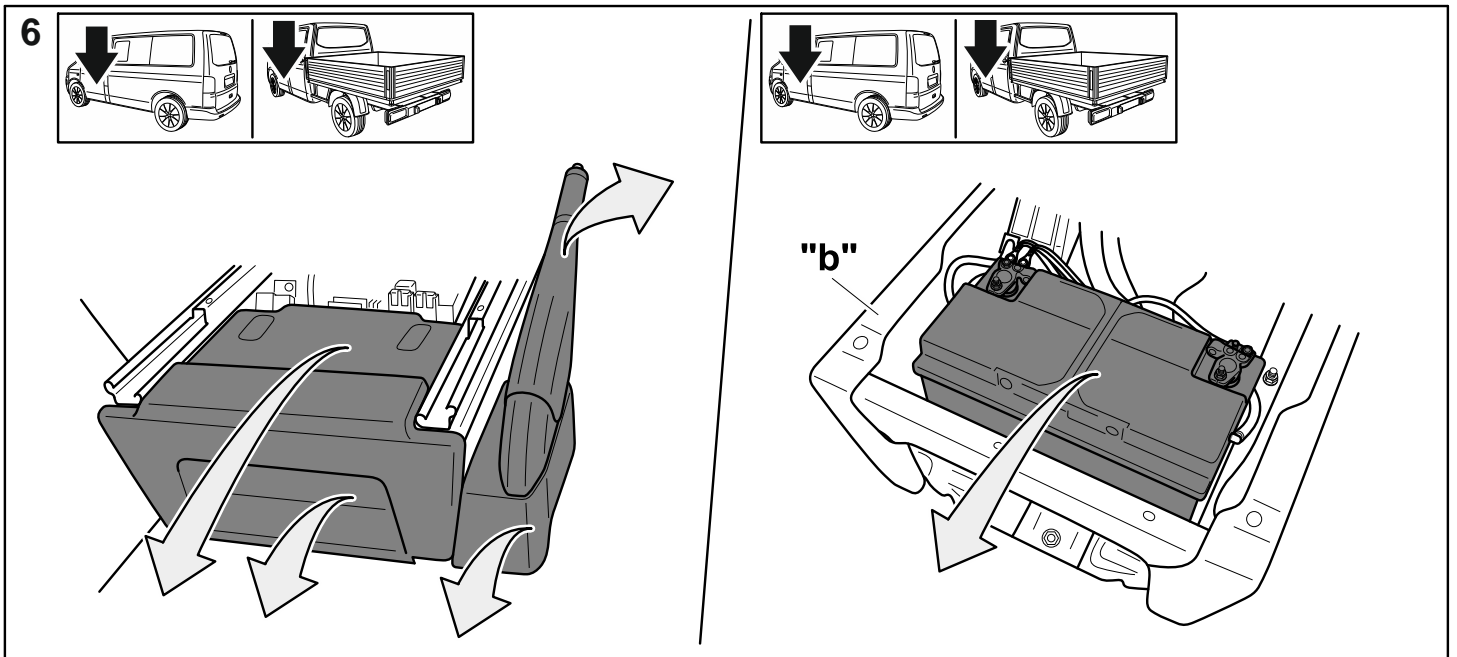
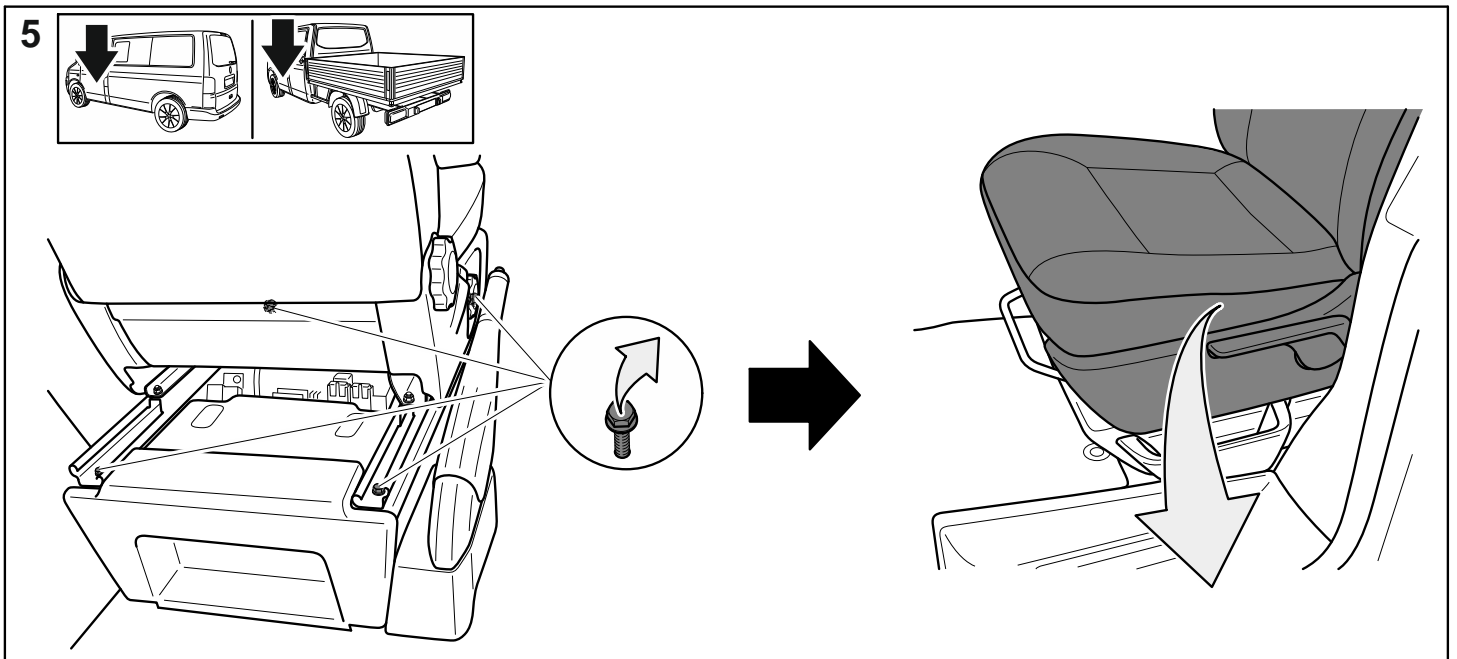
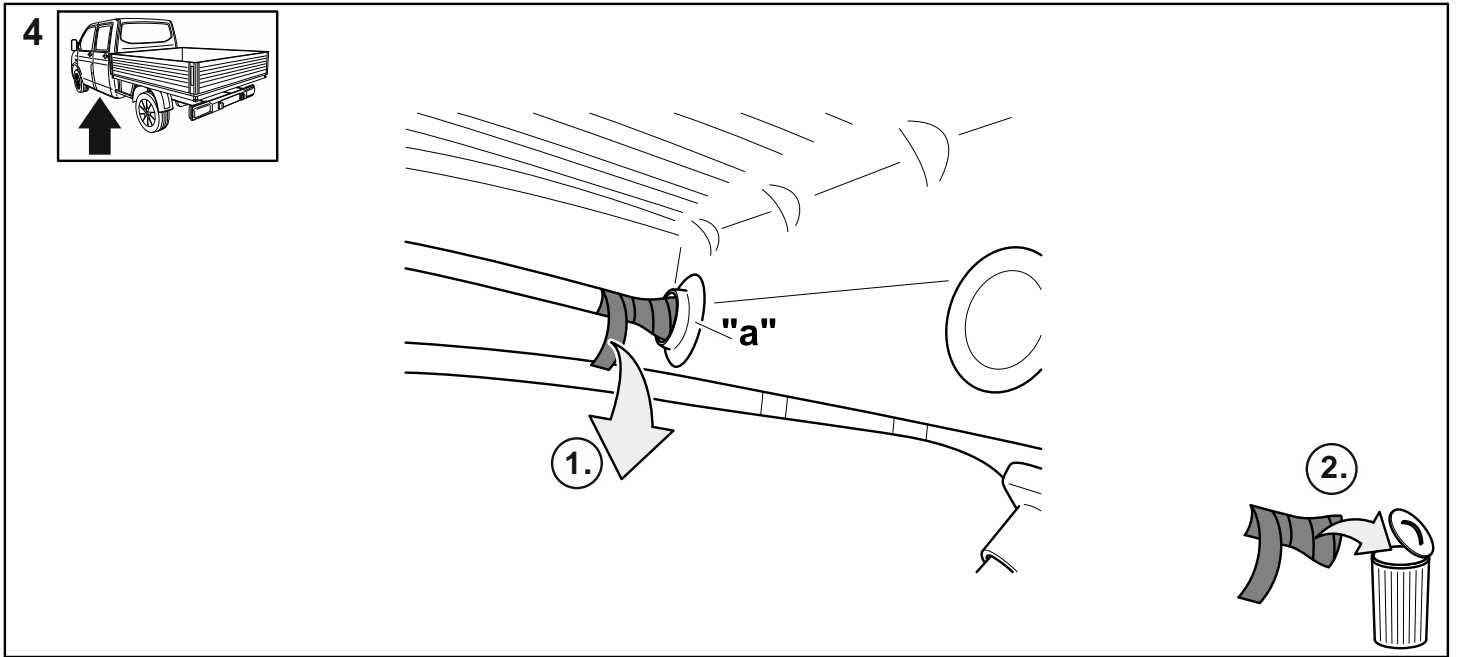

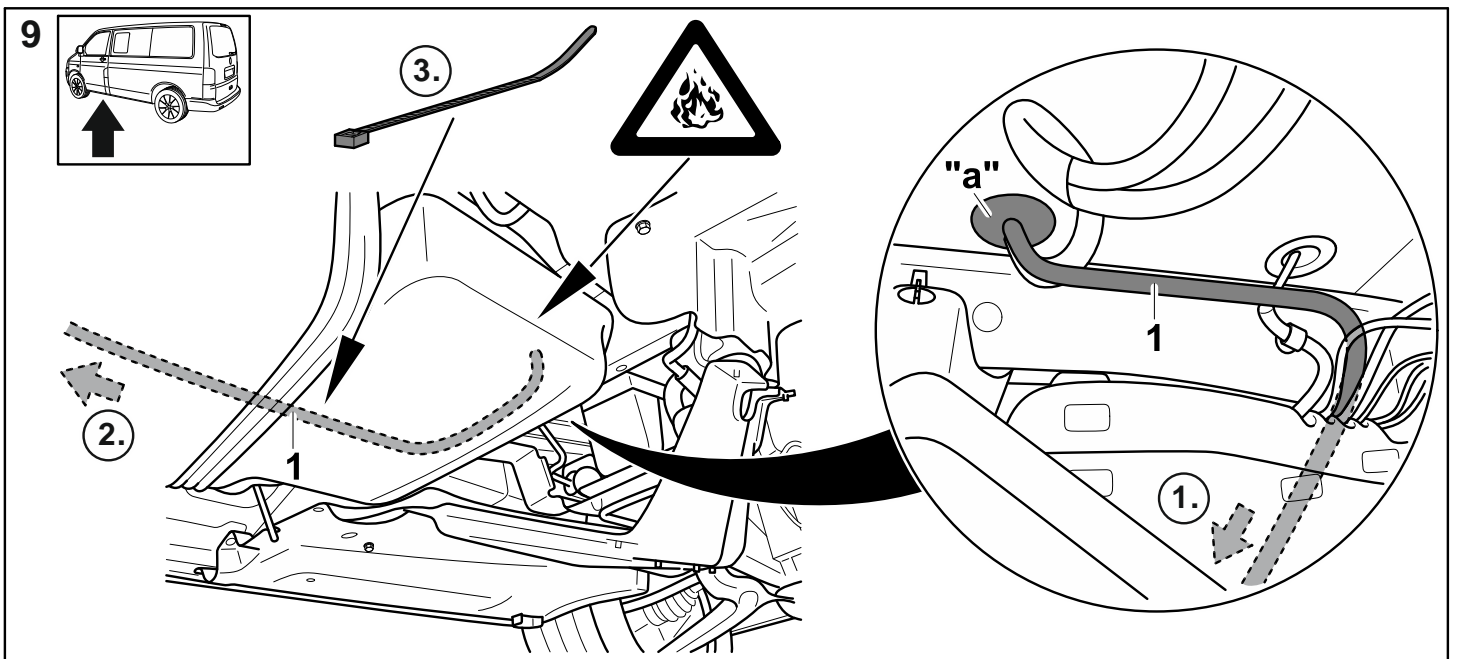
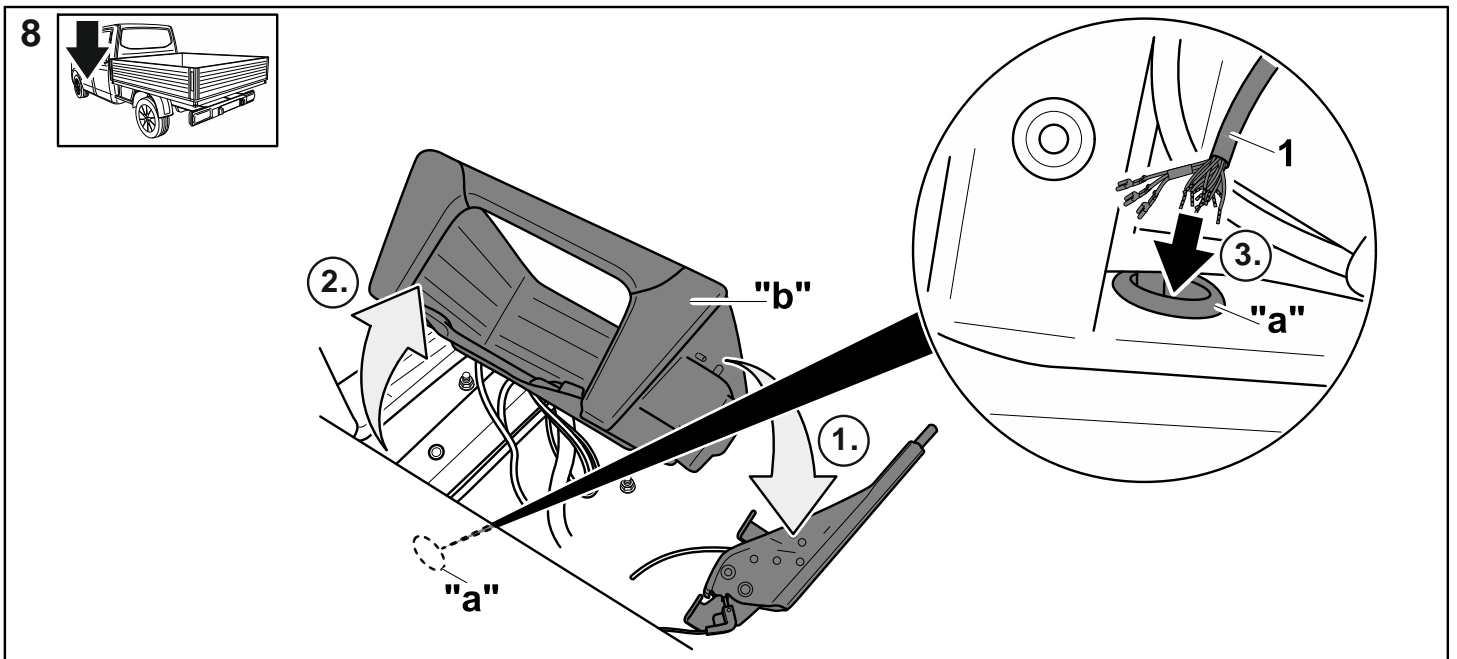
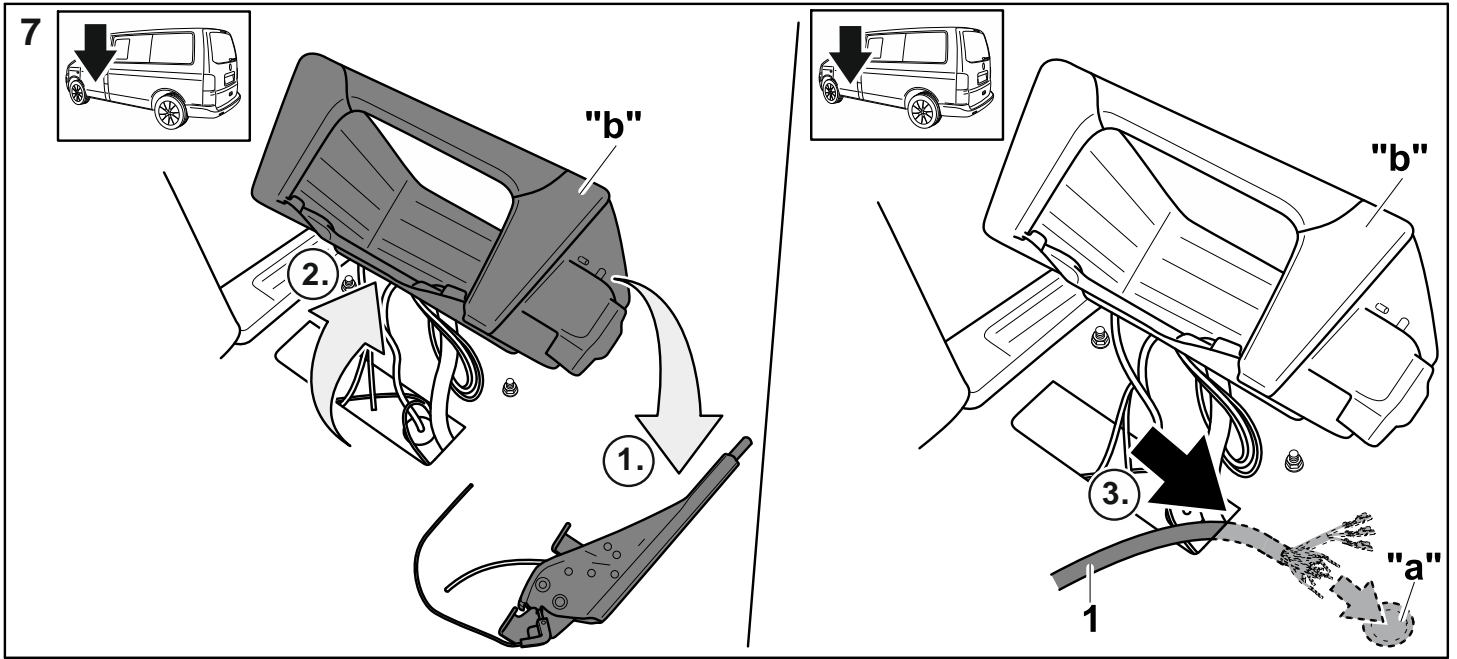

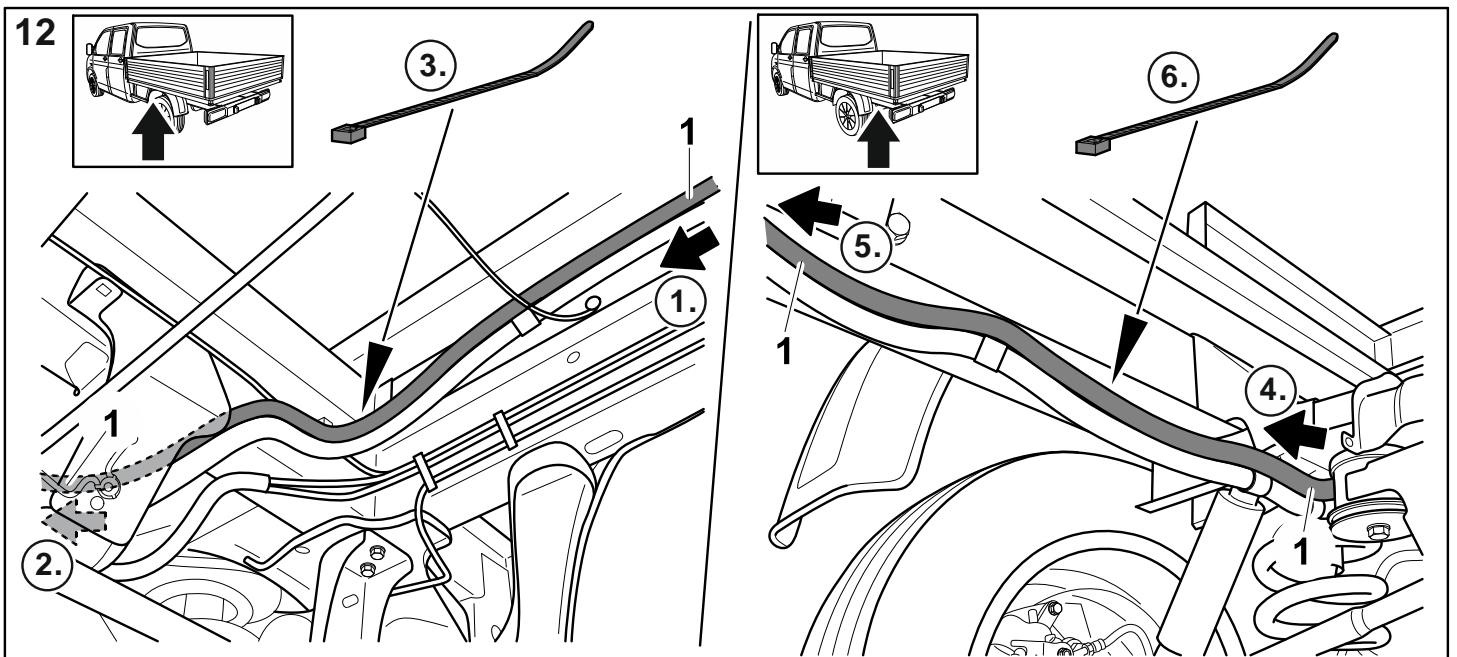
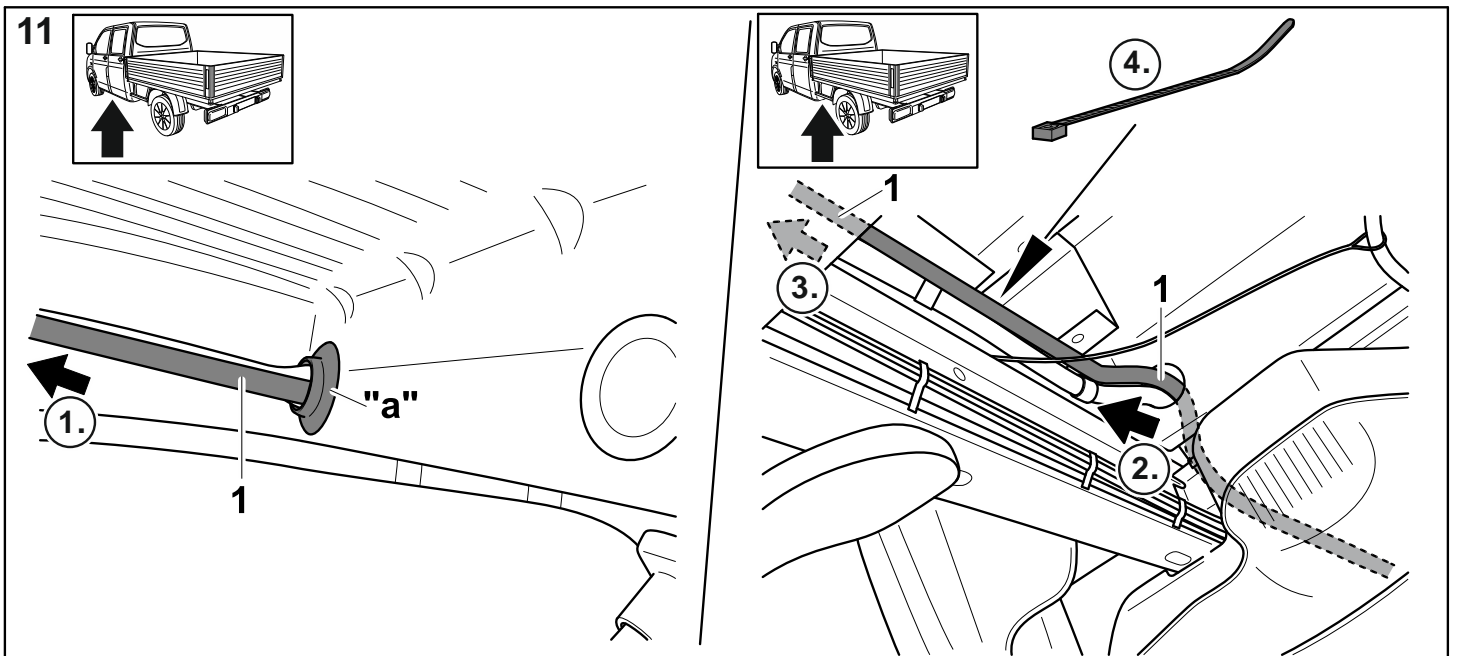
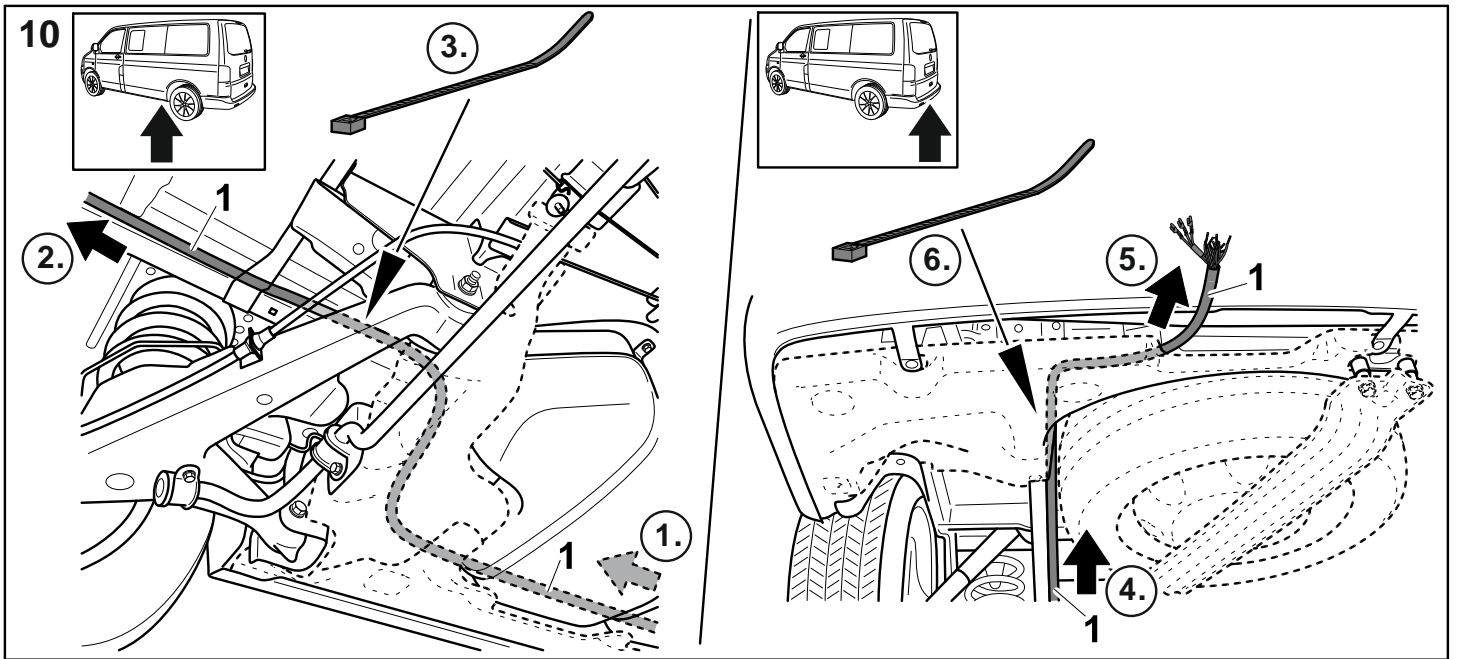

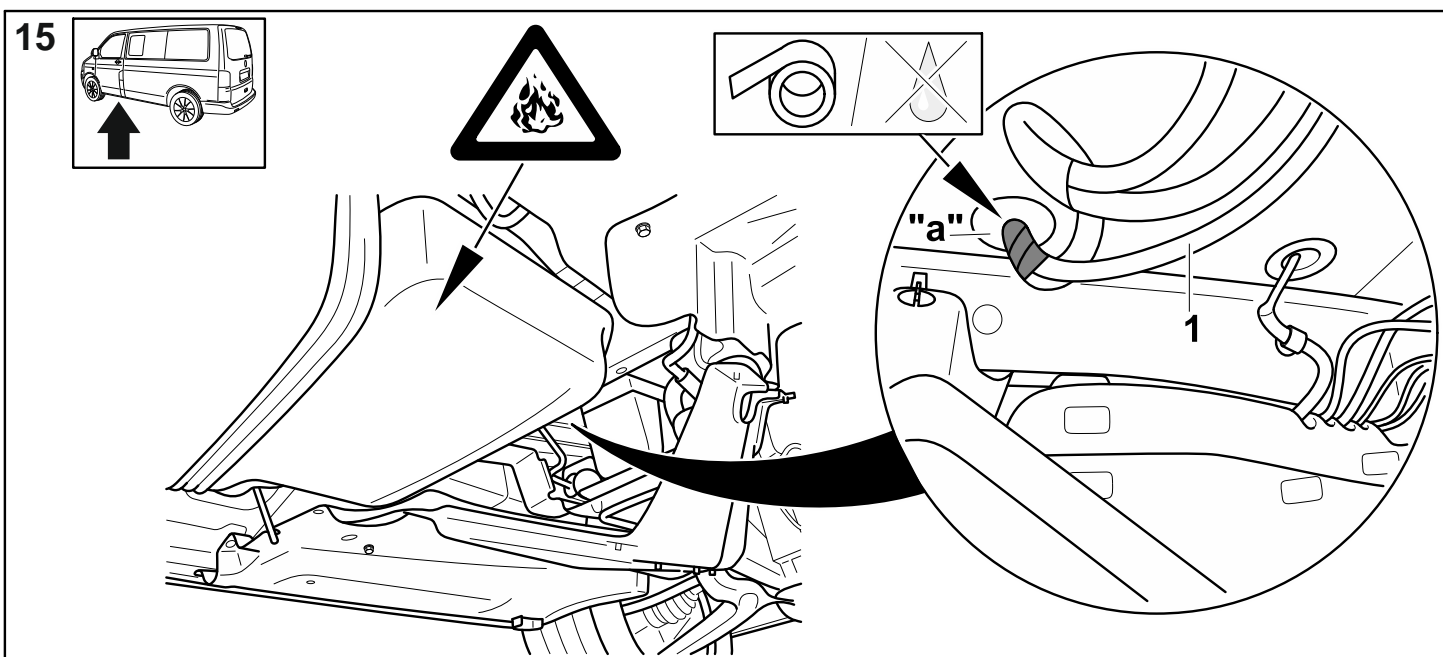
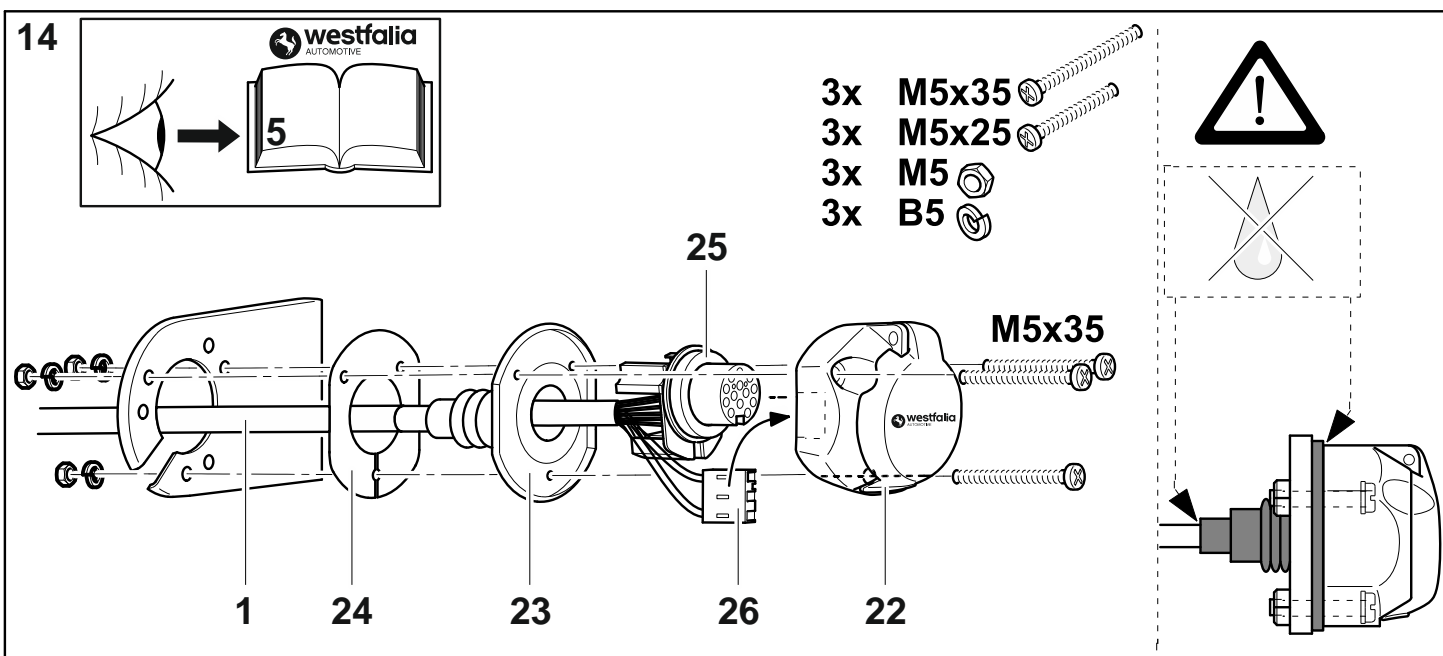
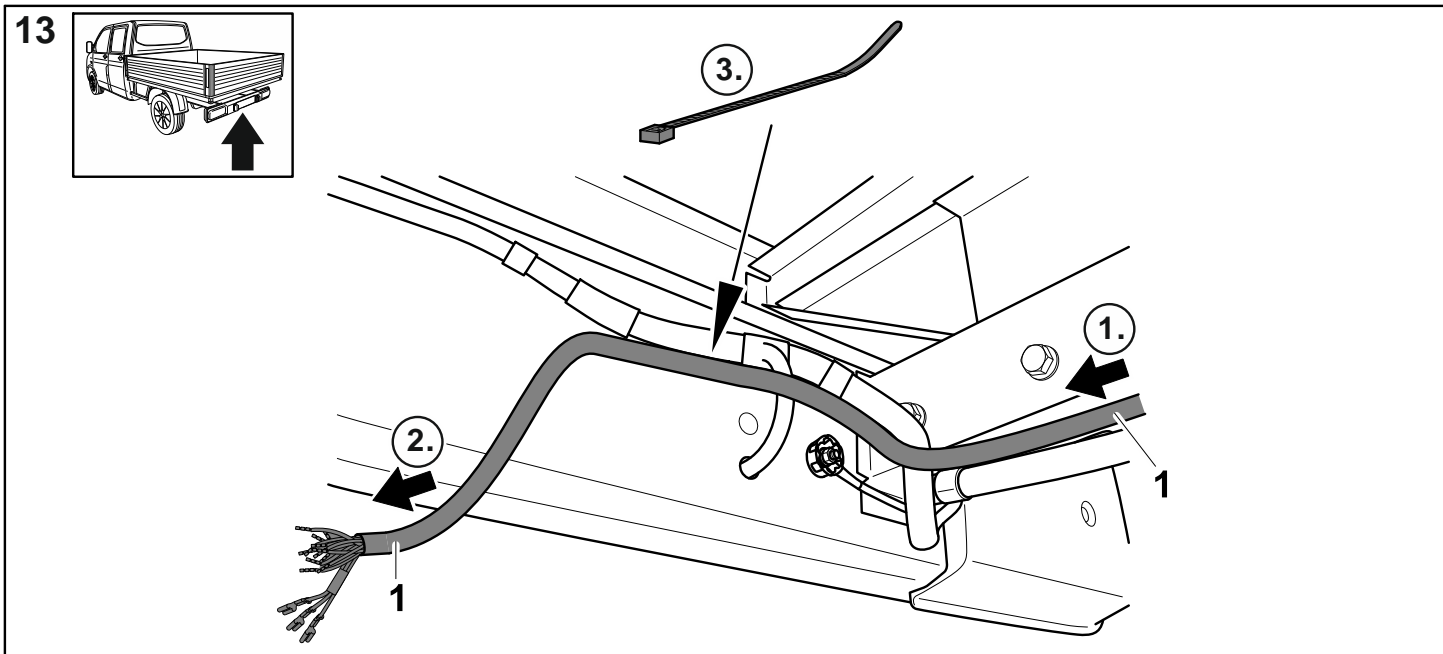

16

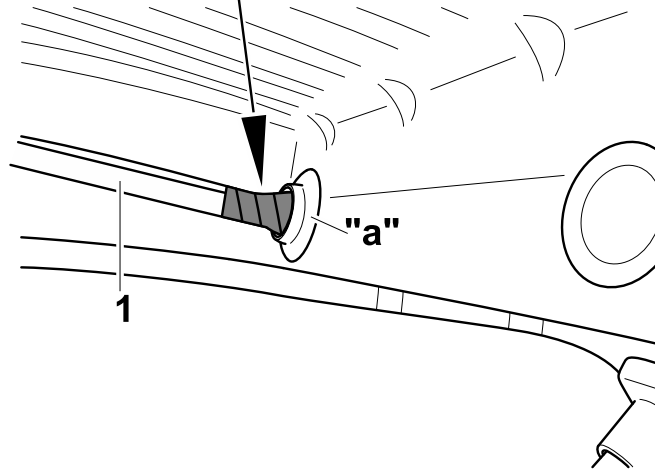
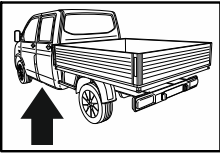

17

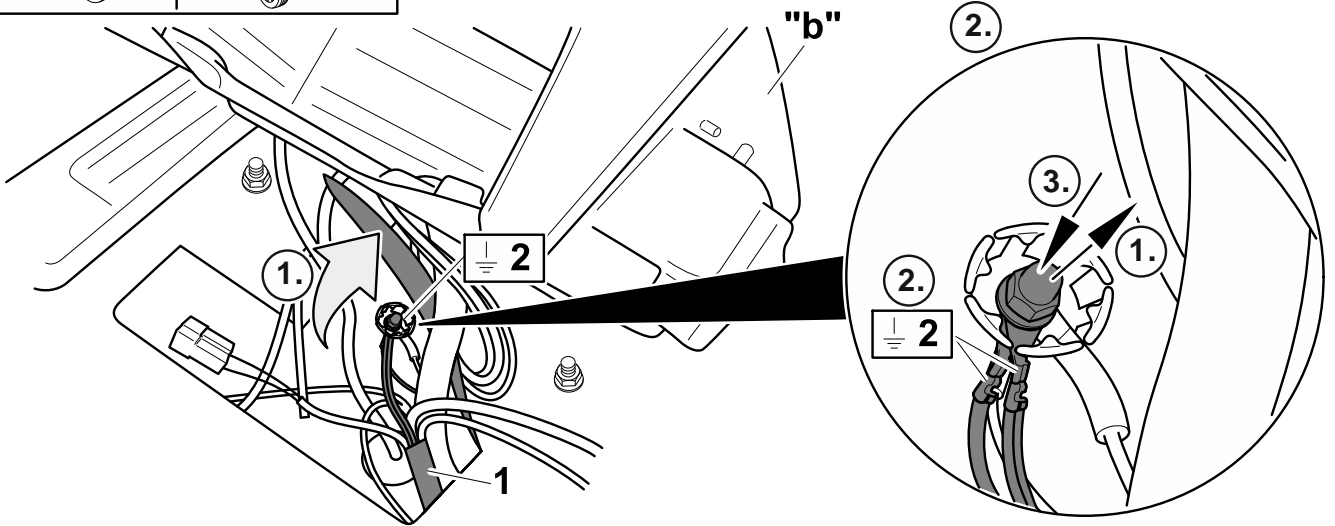
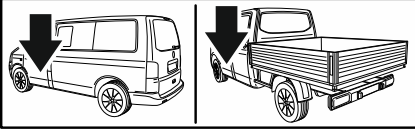

18

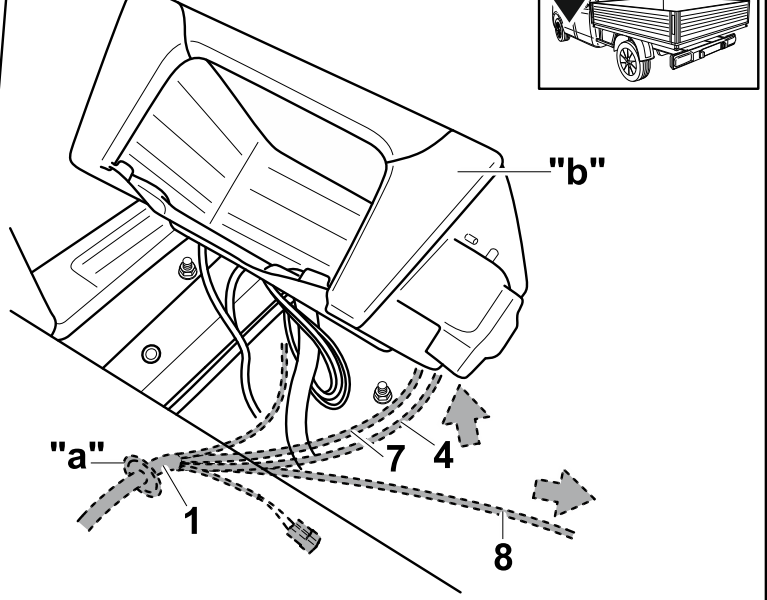
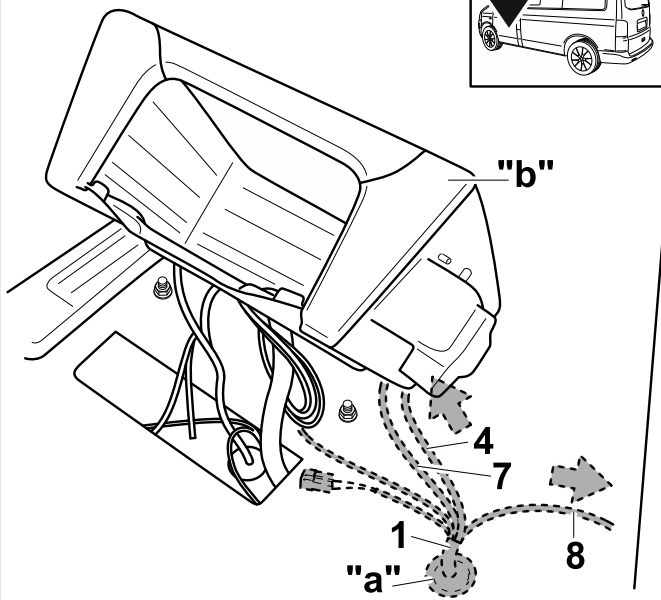
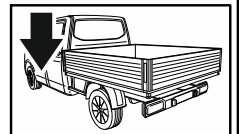
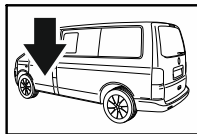

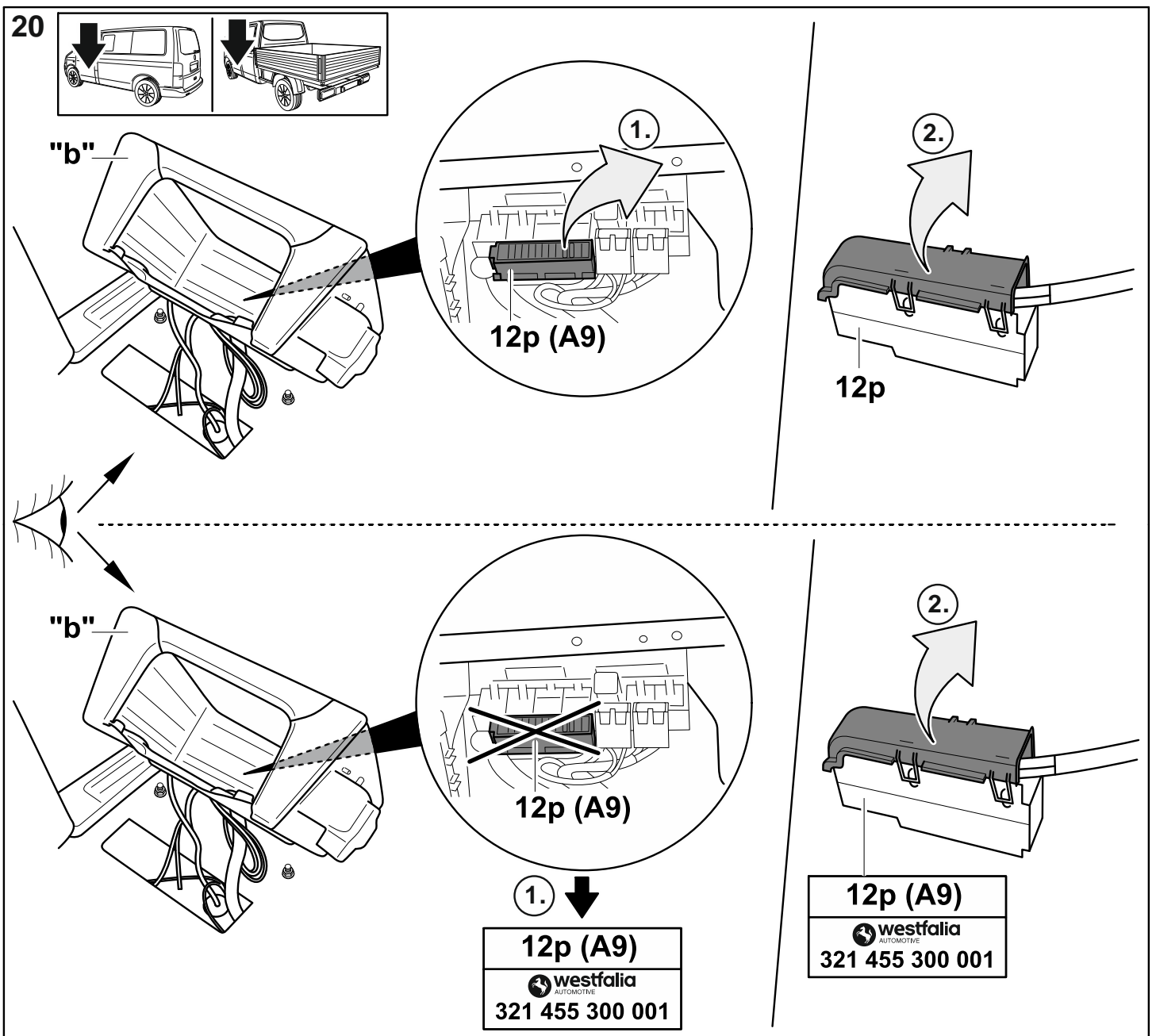
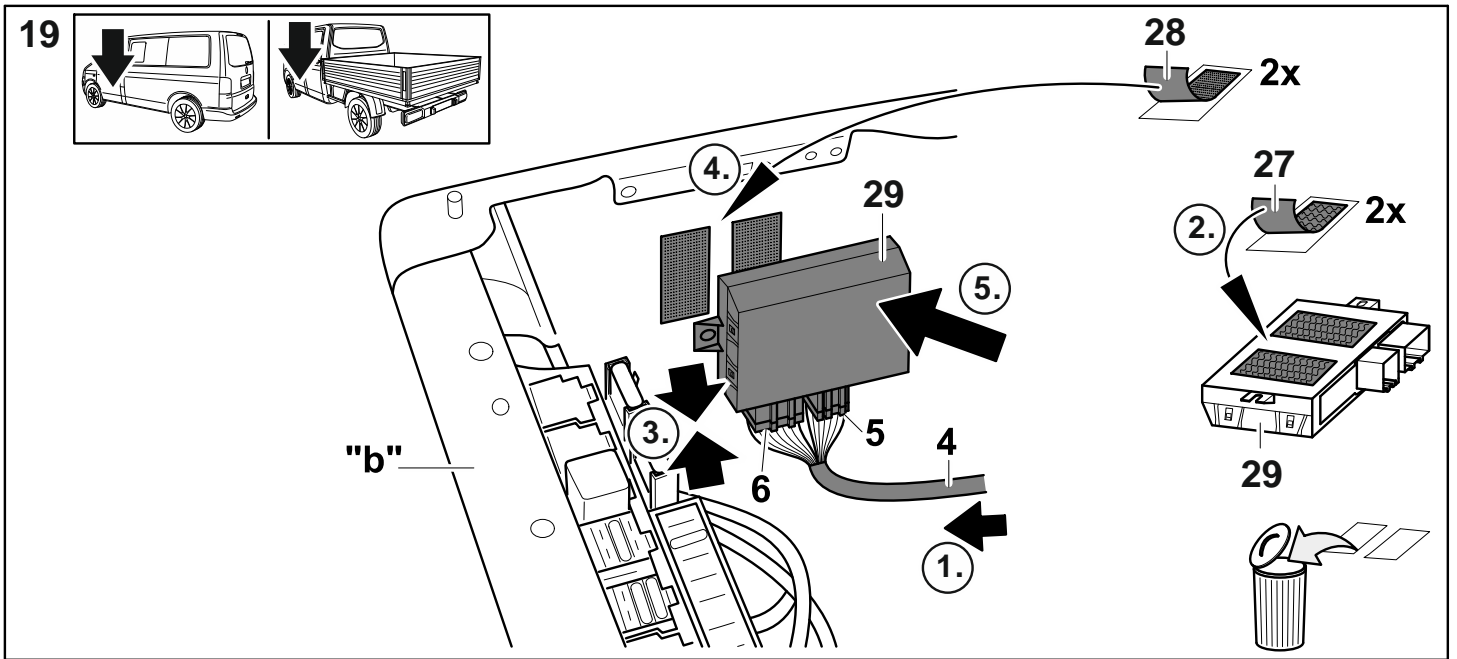

21

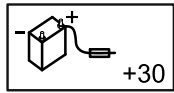

rd → Pin 4
 rd/bk → Pin 5
 rd/bu → Pin 6

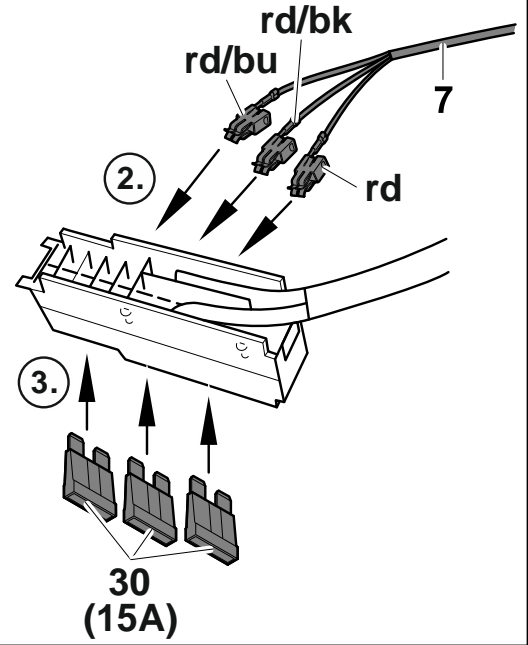
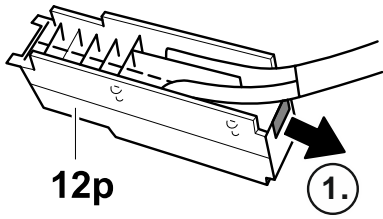

22

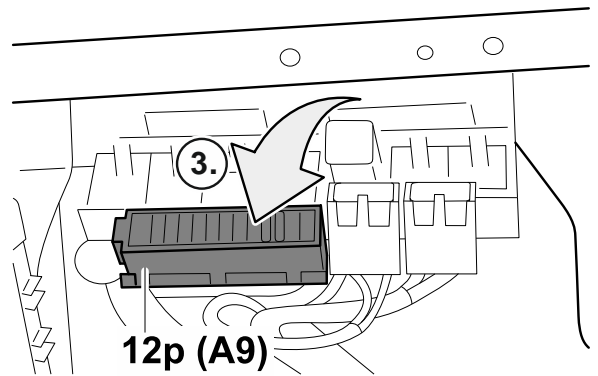
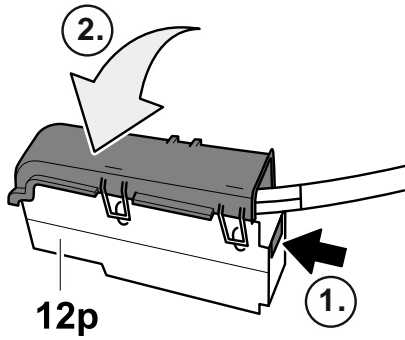
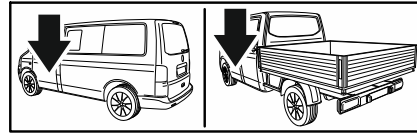

23

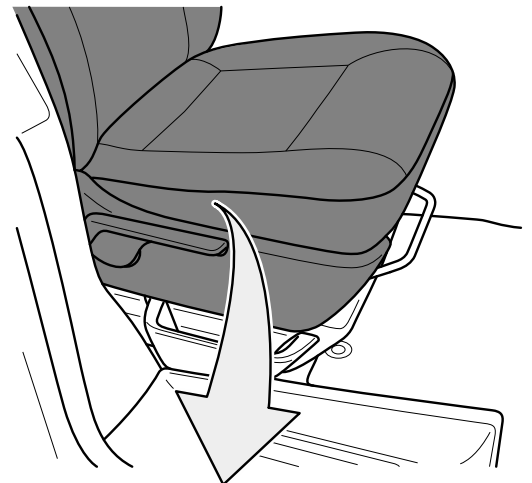
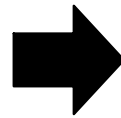
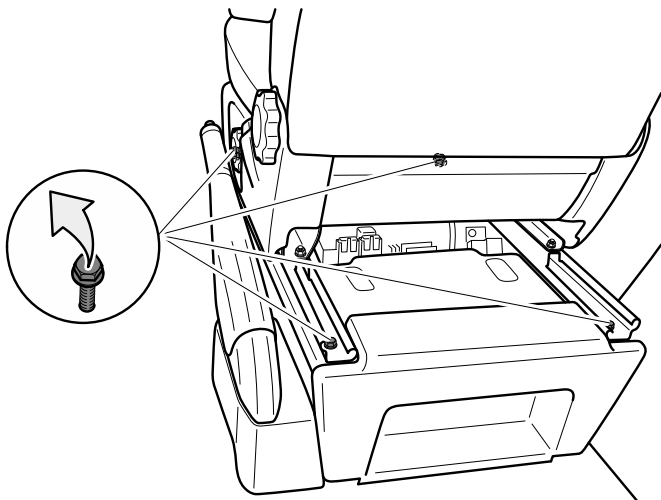
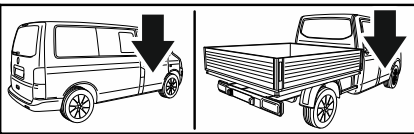

24

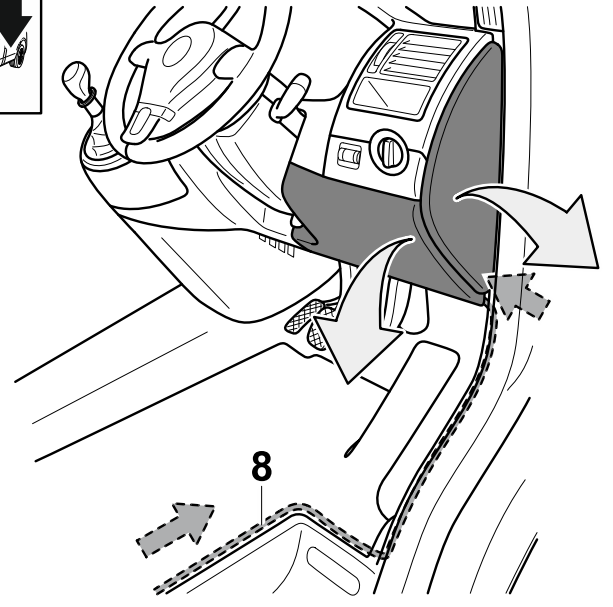
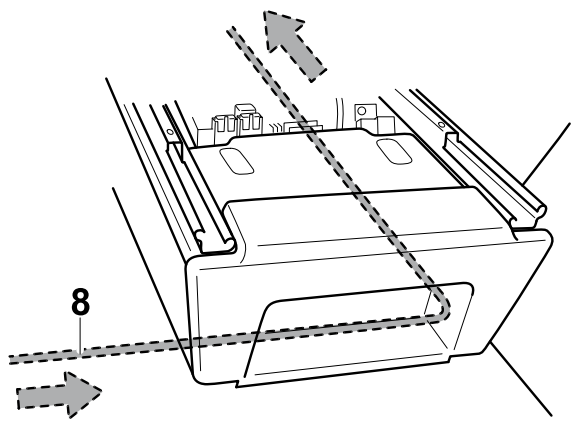
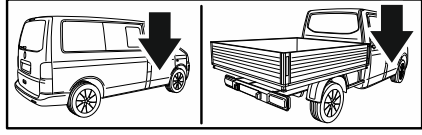

25

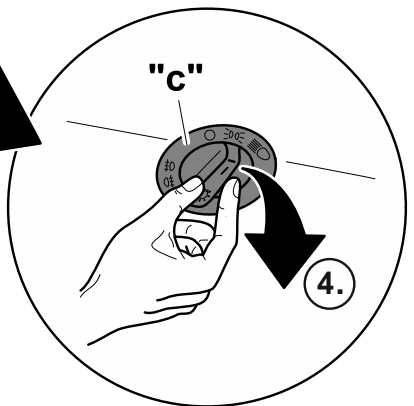
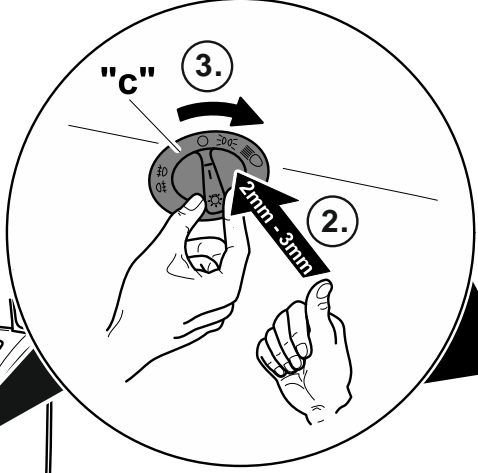
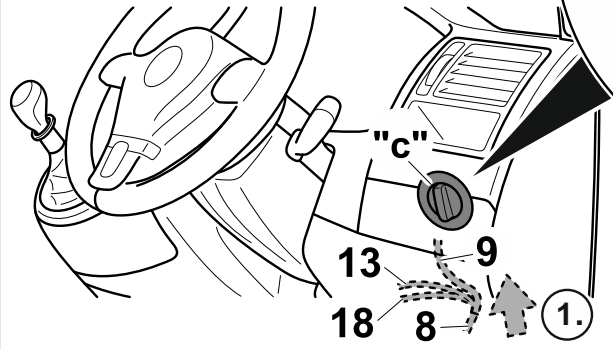
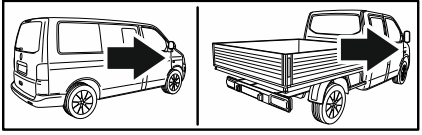

26

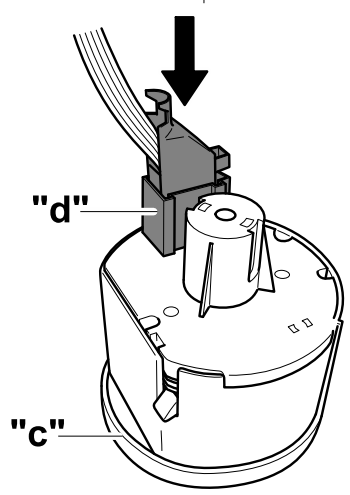
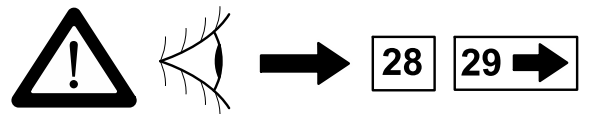
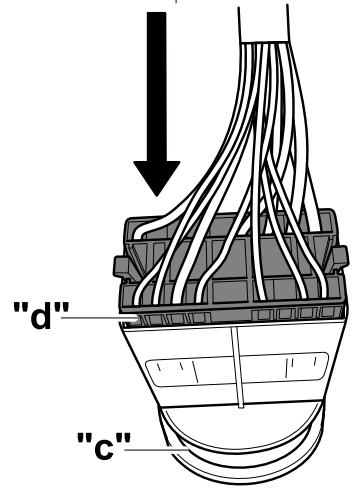
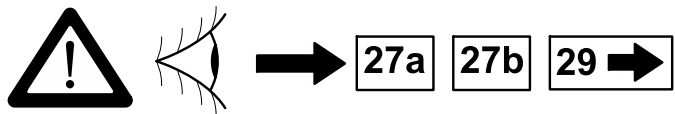

27a

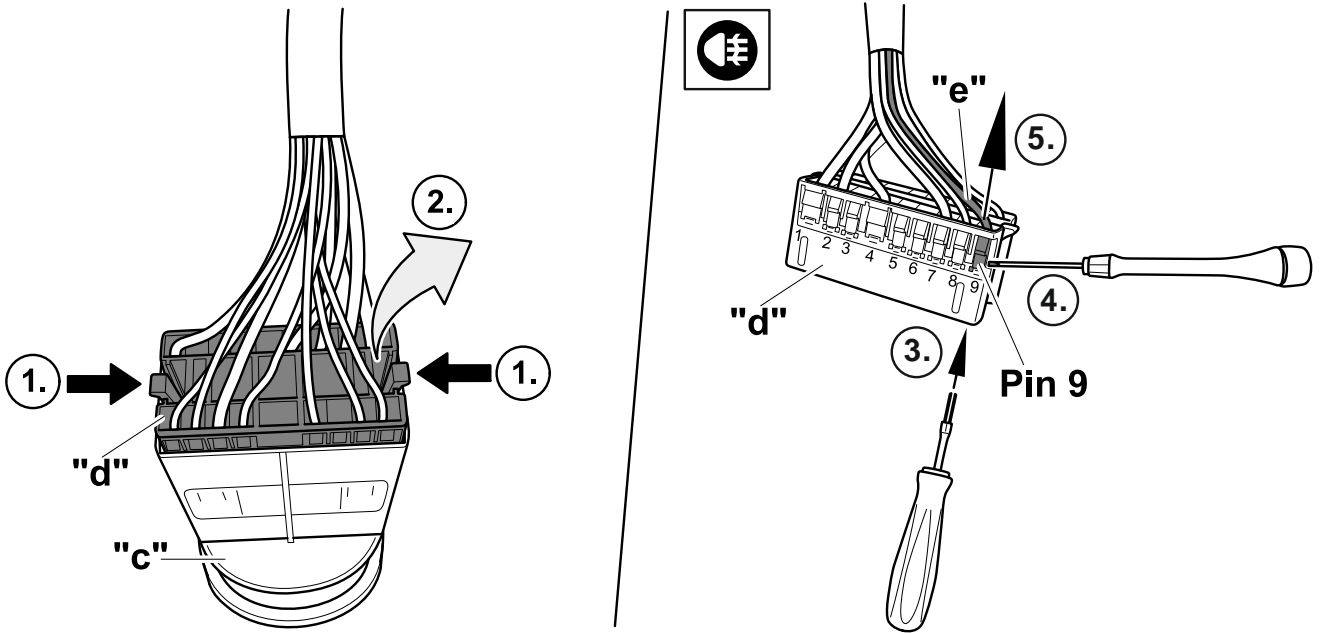

27b

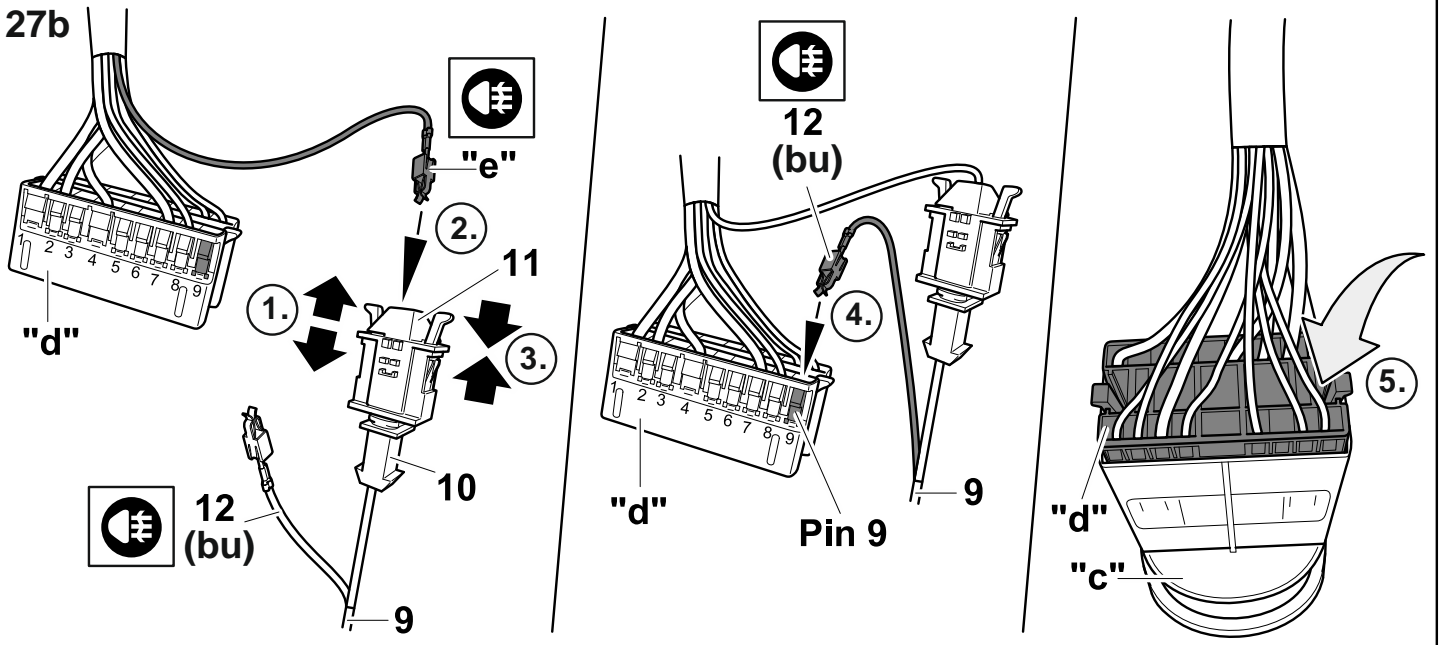

28

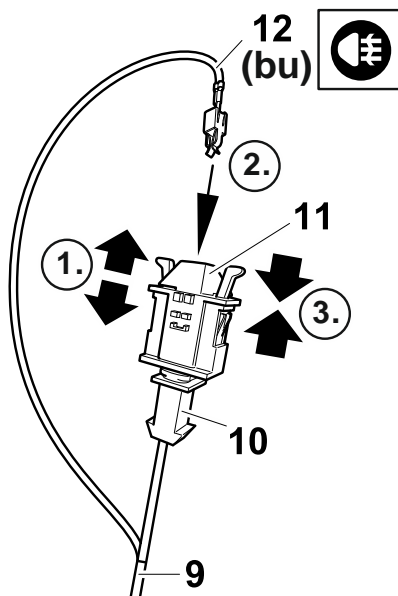

29

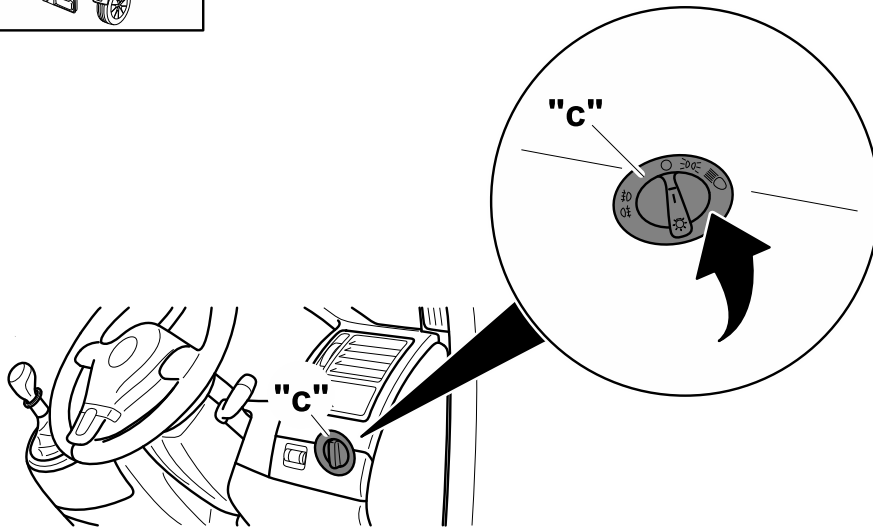
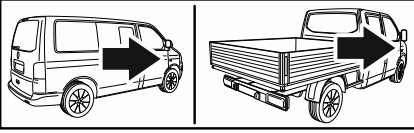

30

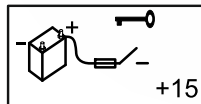
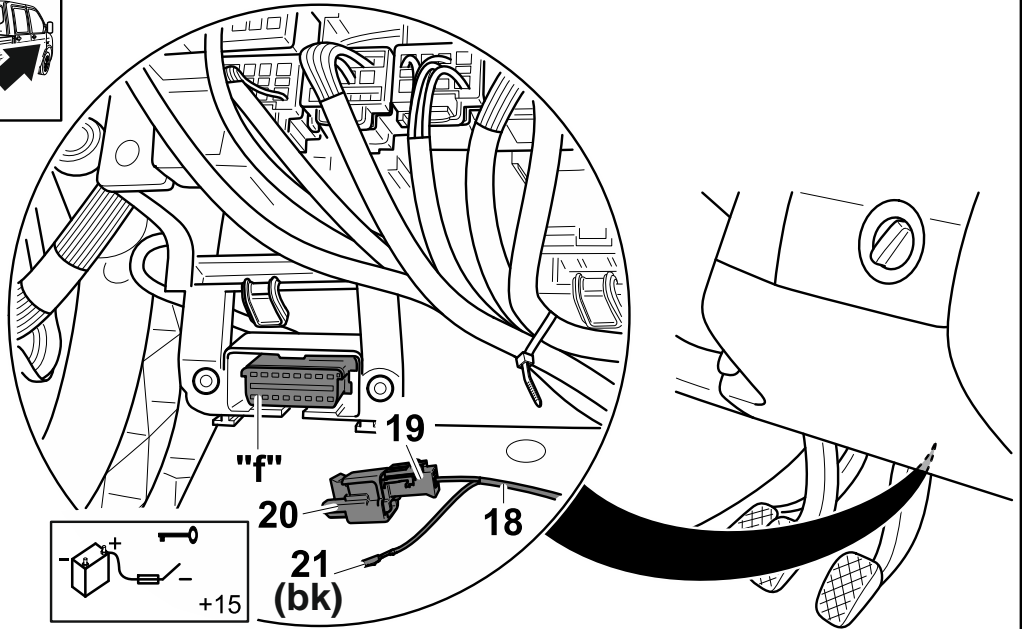
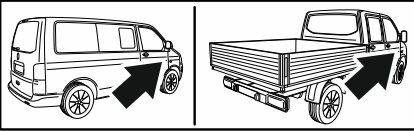

31

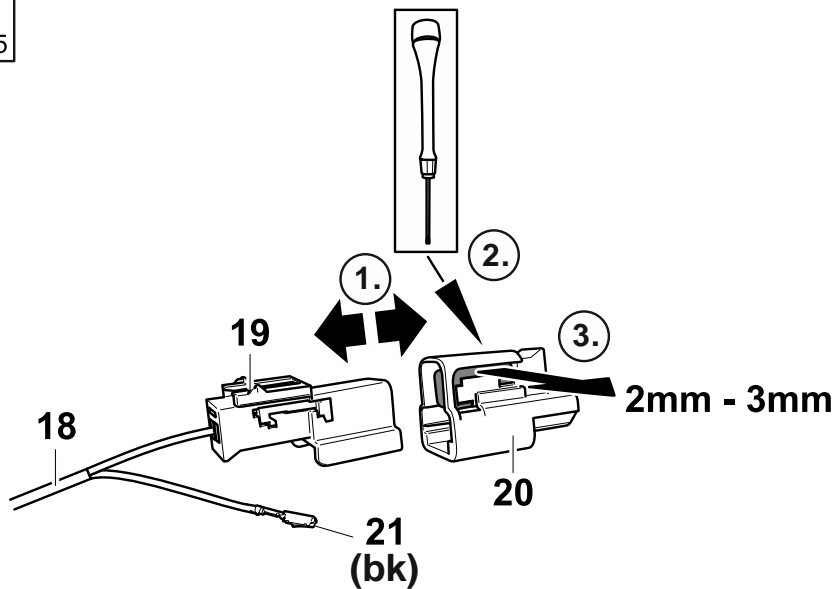
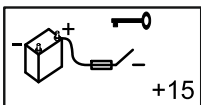

32

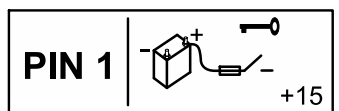
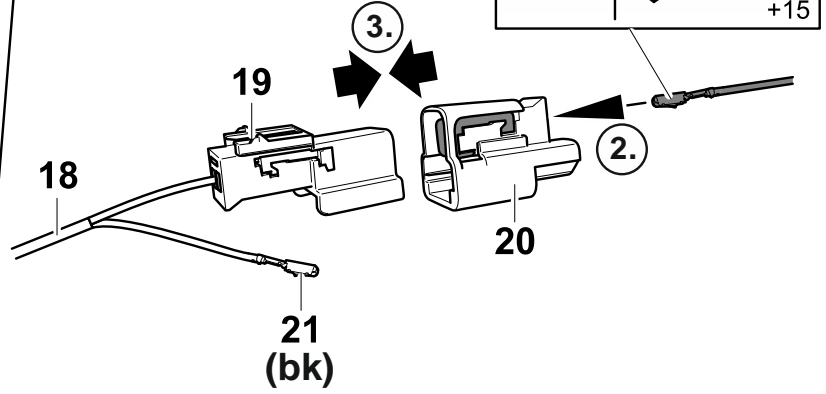
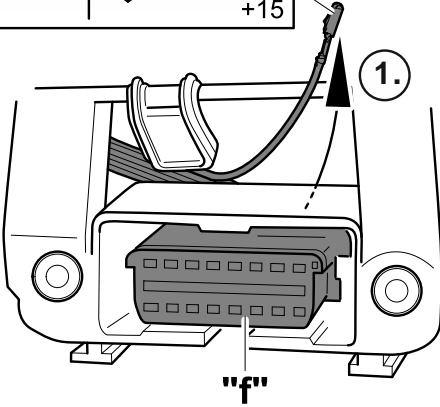
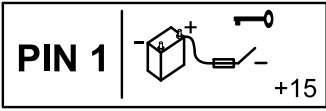
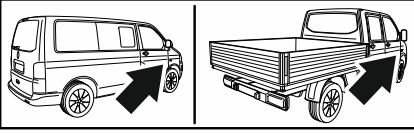

33

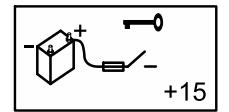
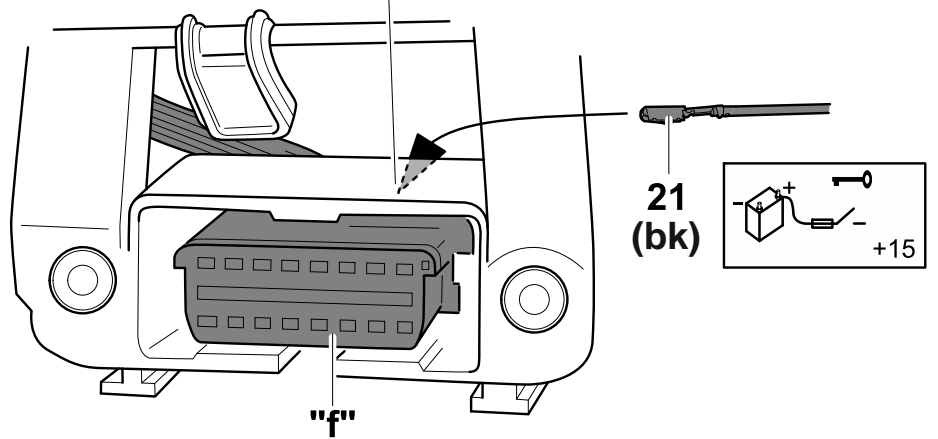
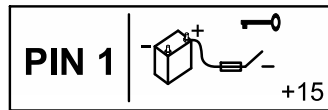
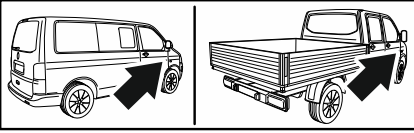

34

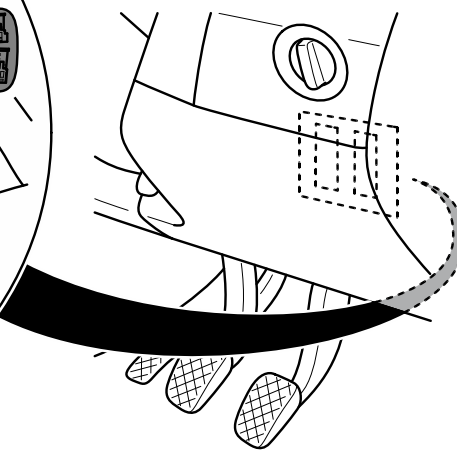
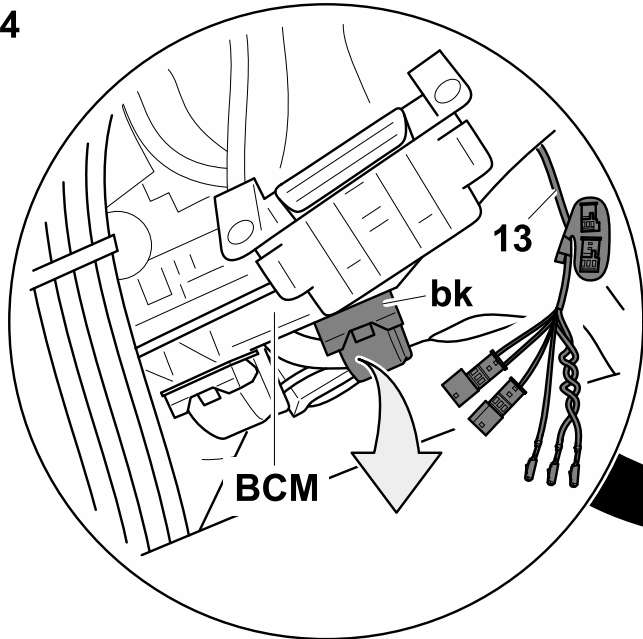
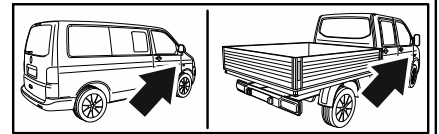

35

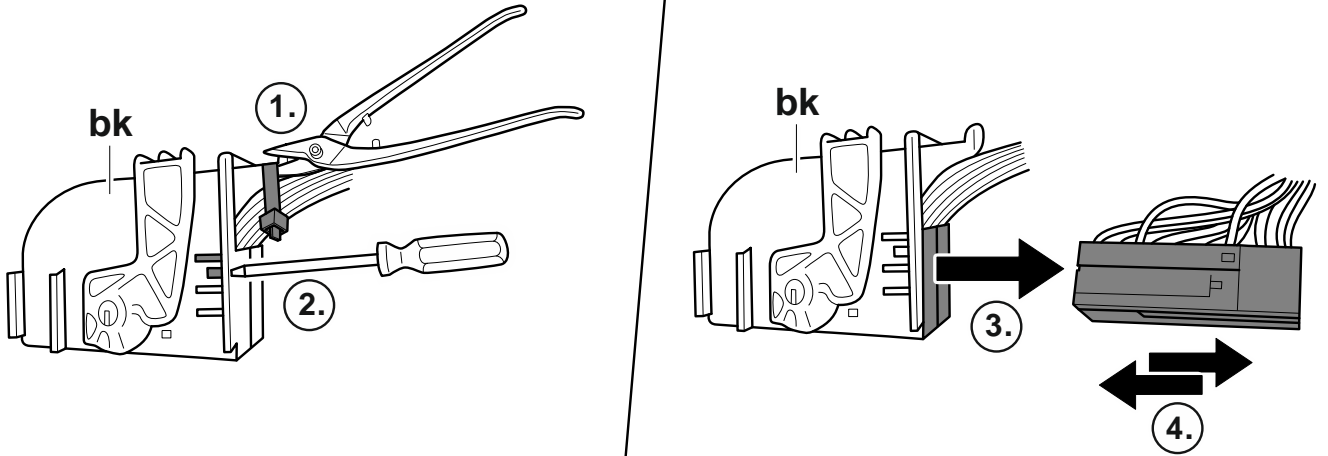

36

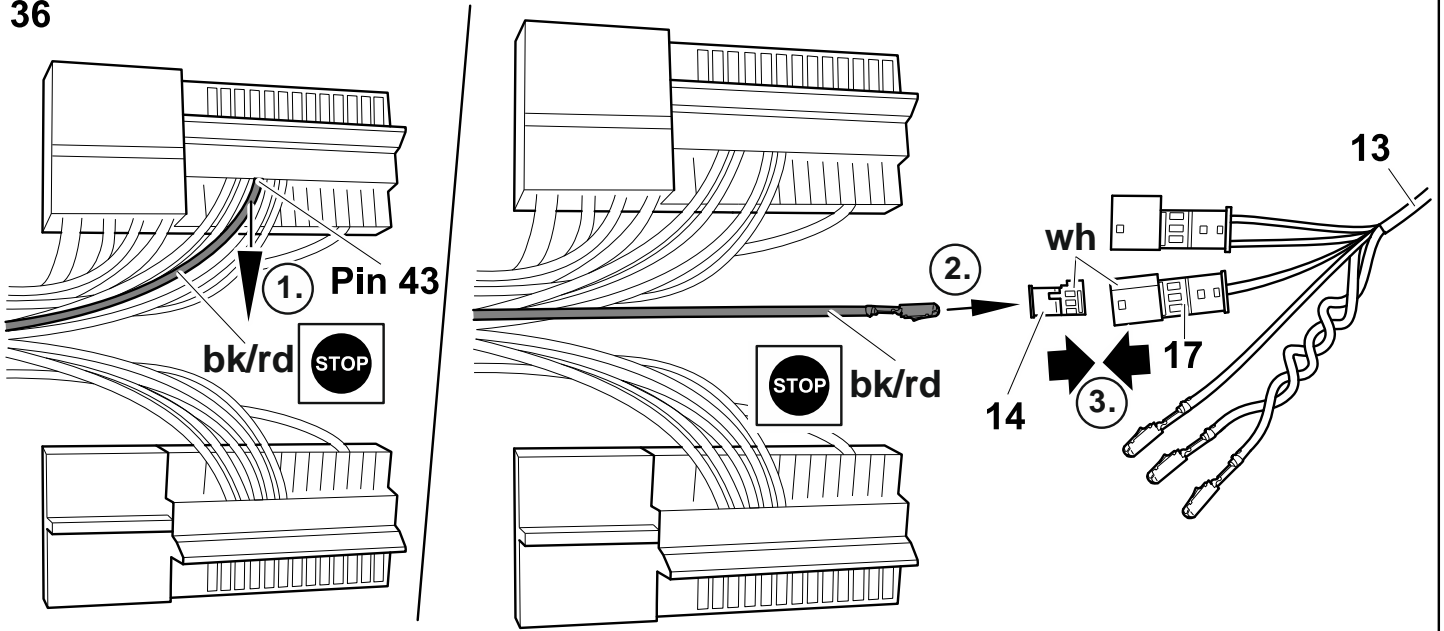

37

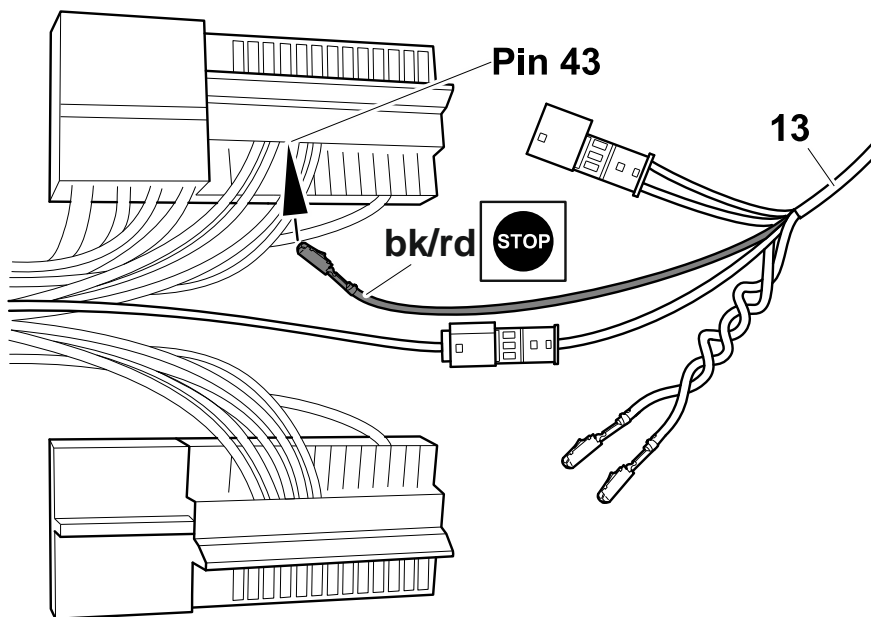

38

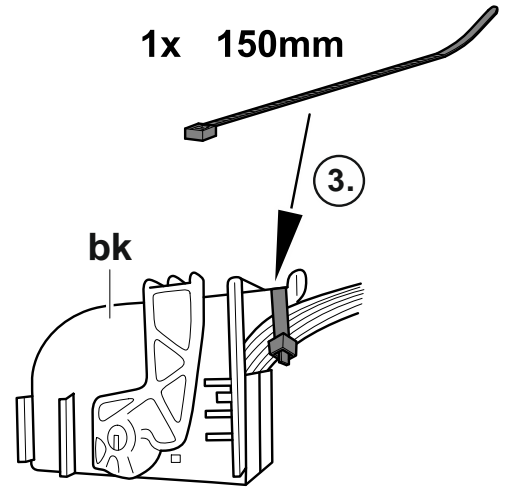
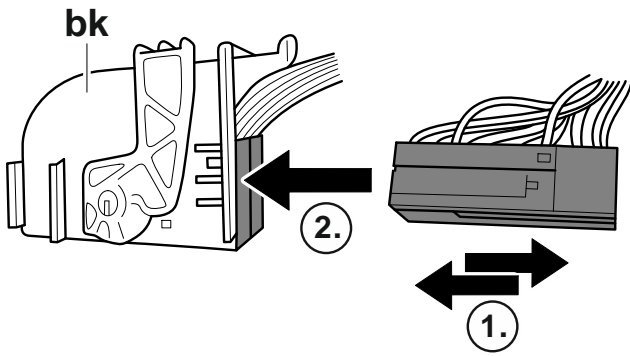

39

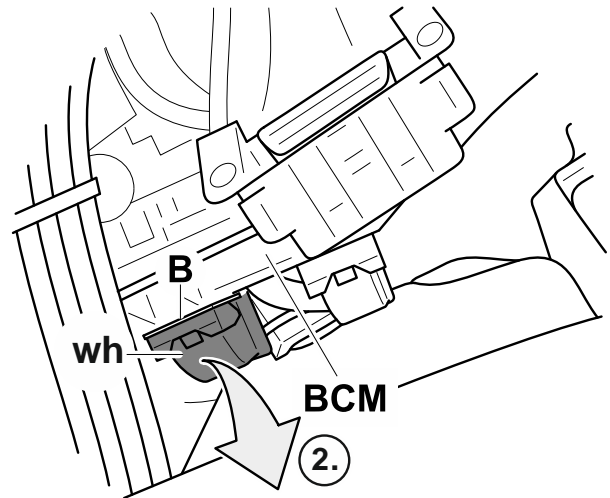
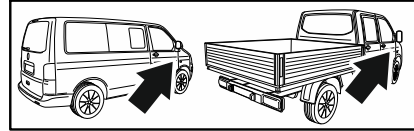
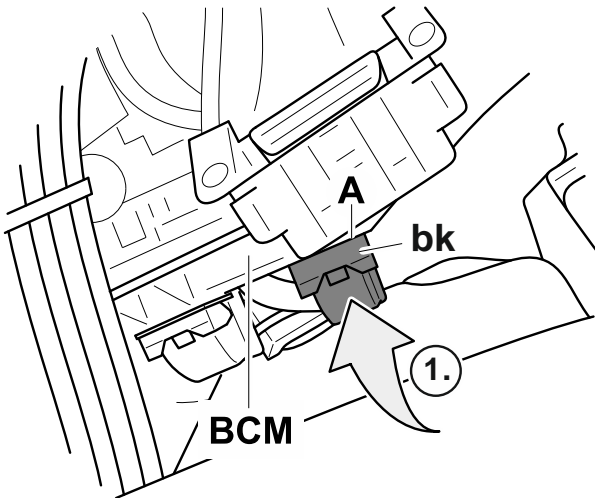
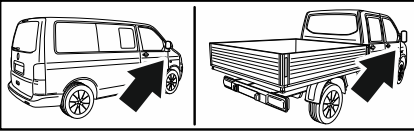

40

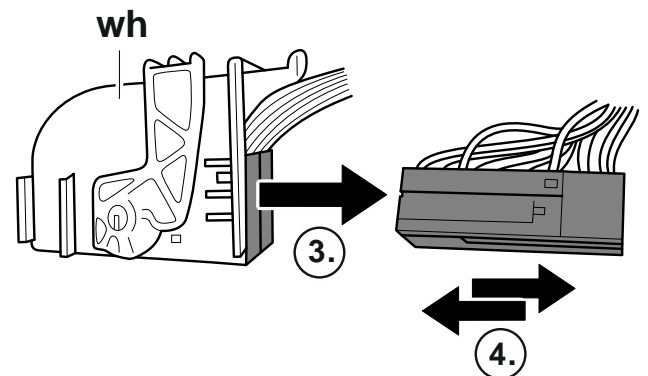
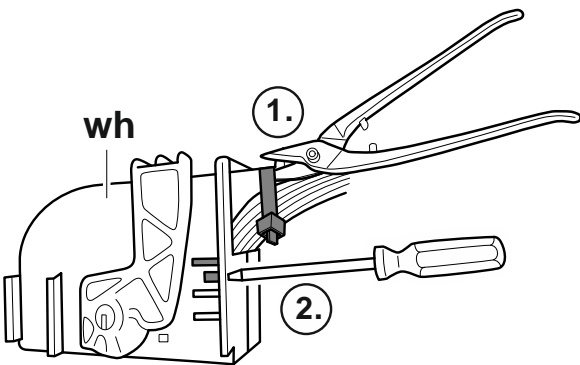

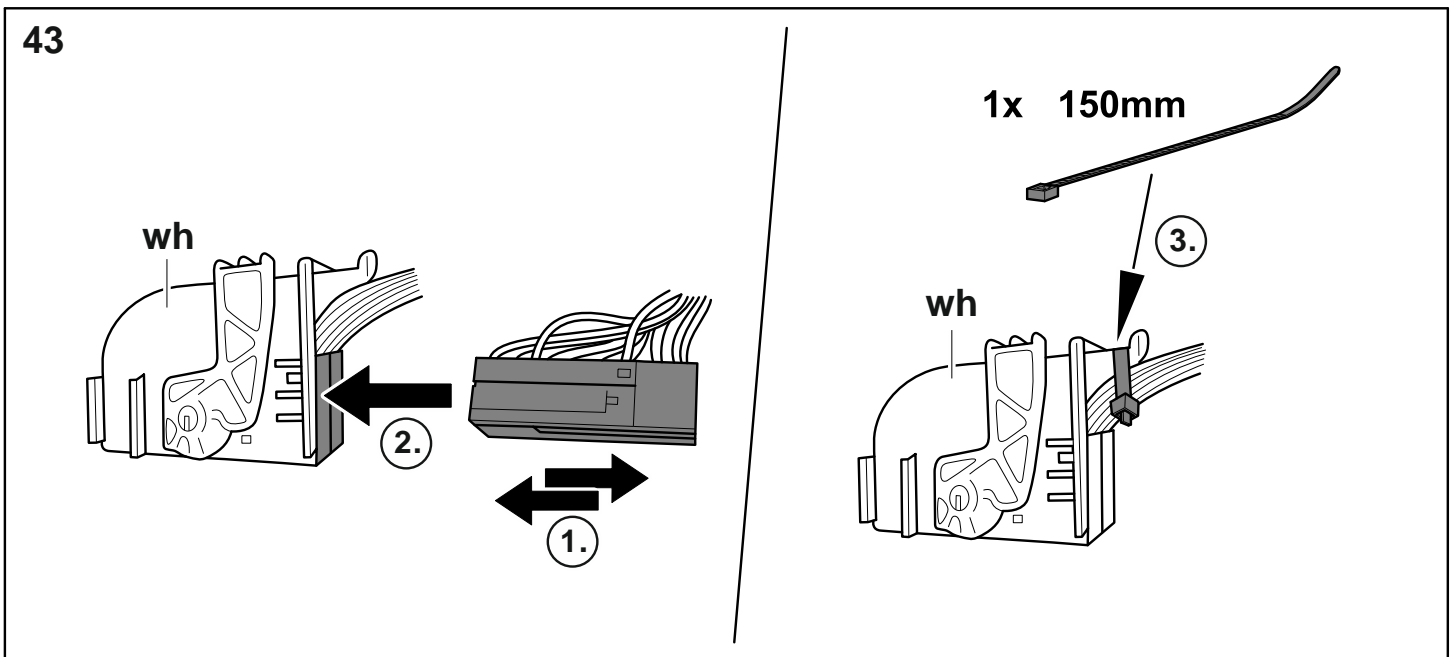
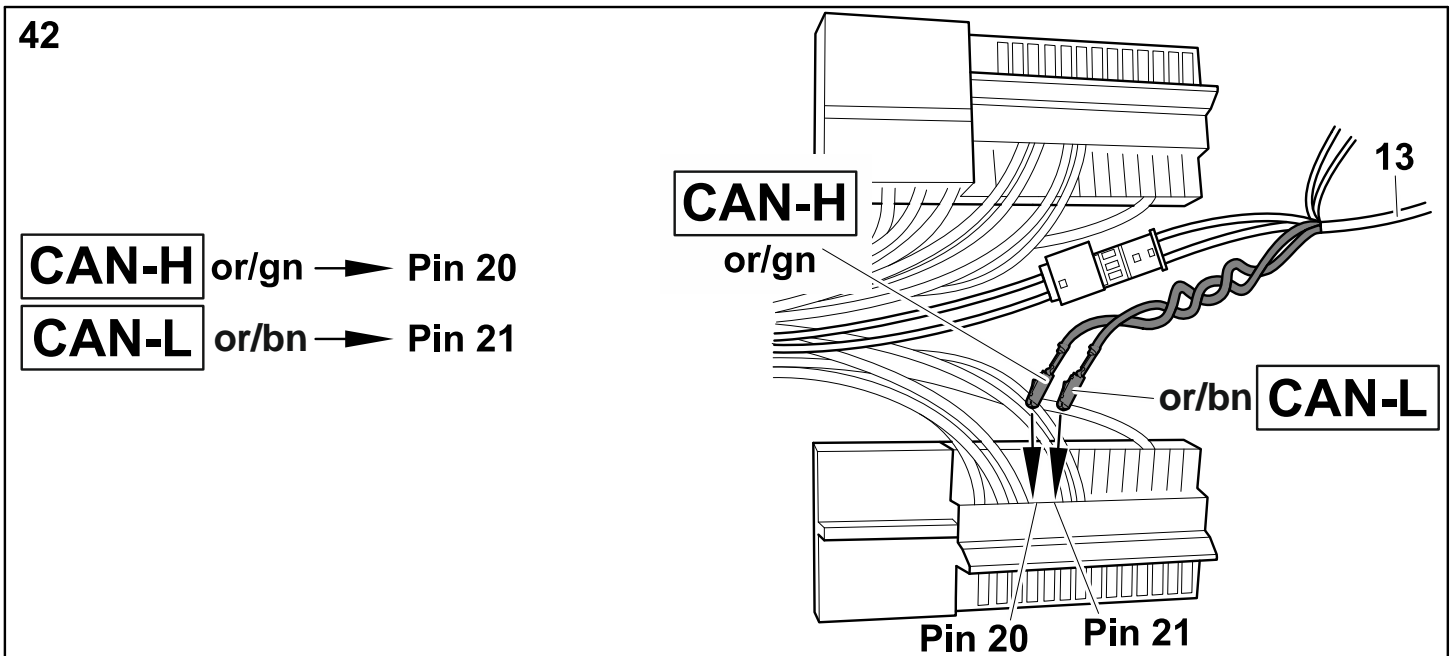
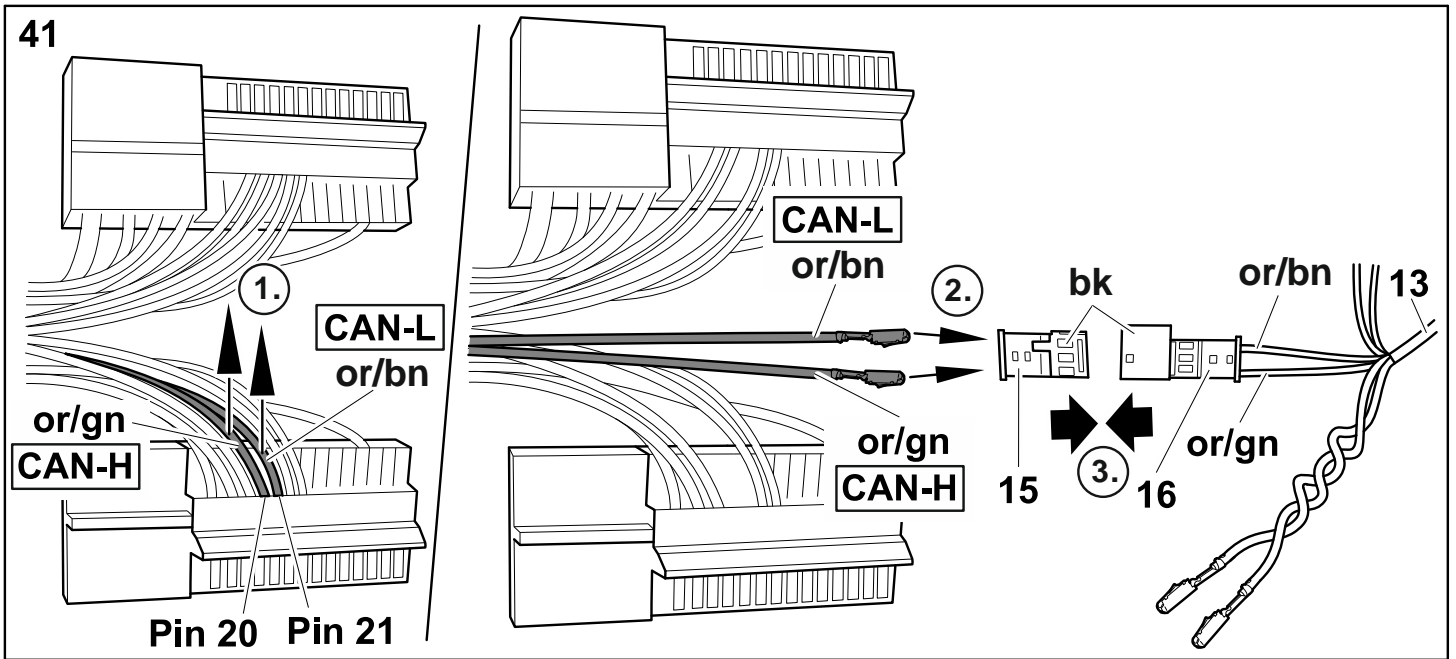

44

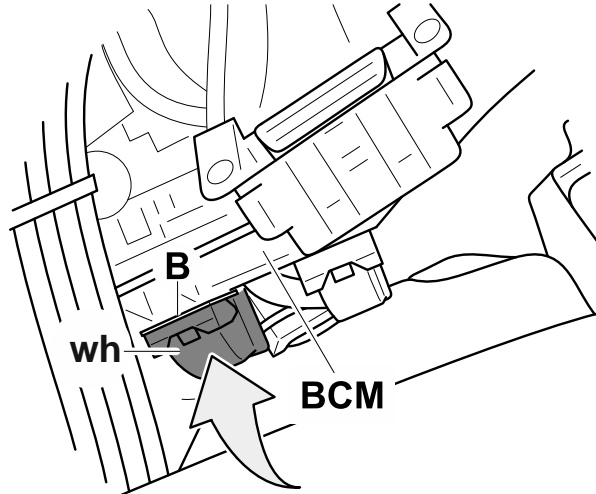
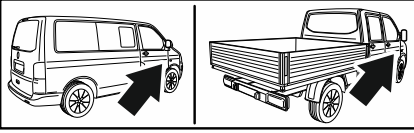

45

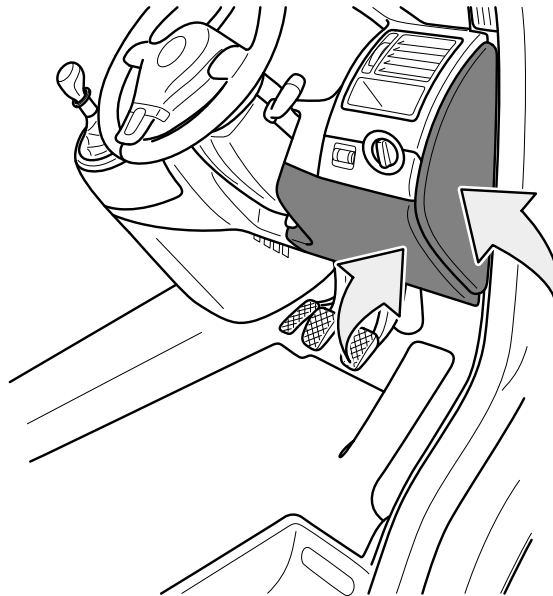
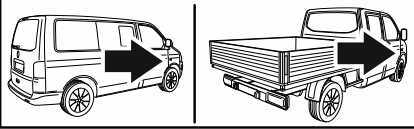

46

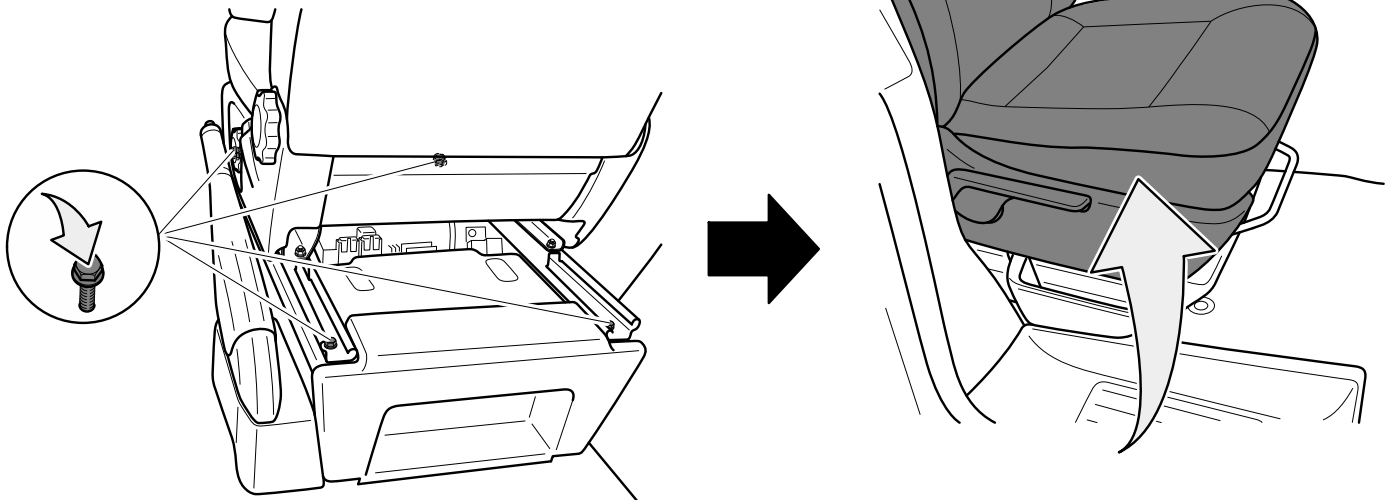
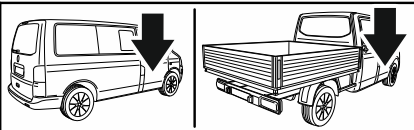

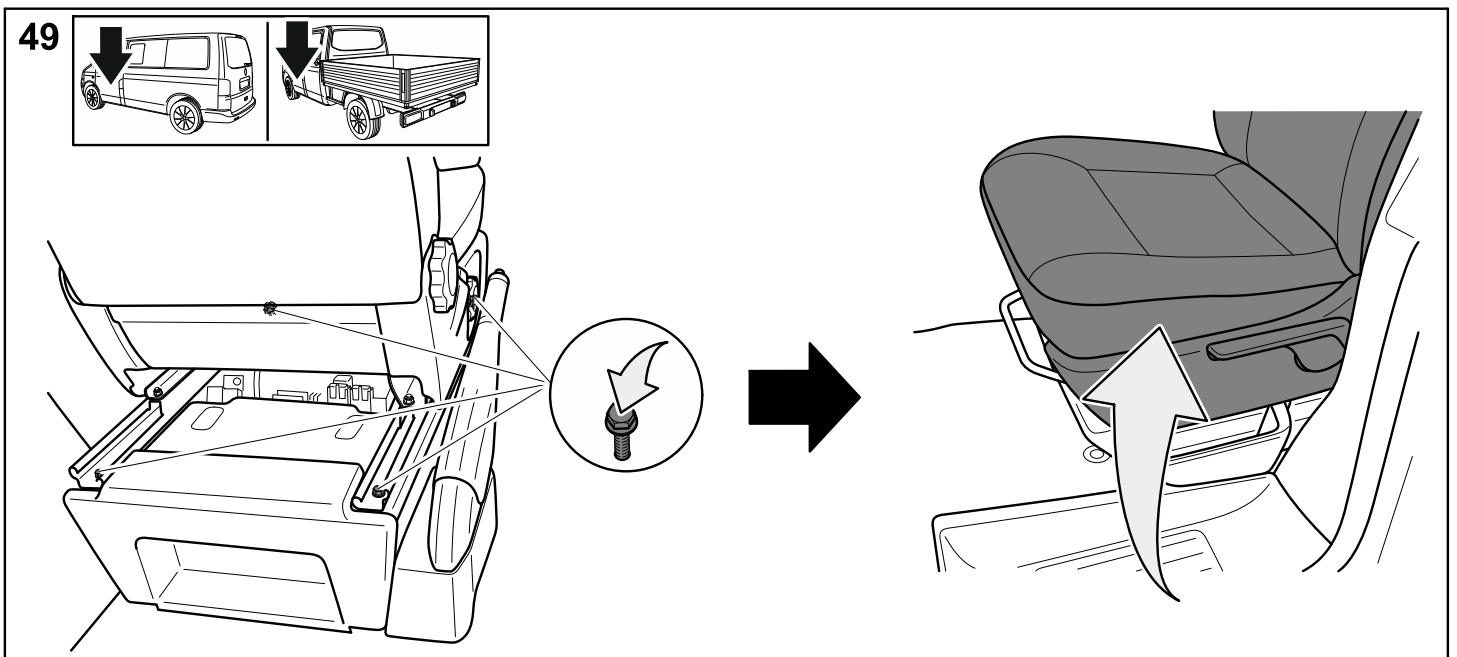
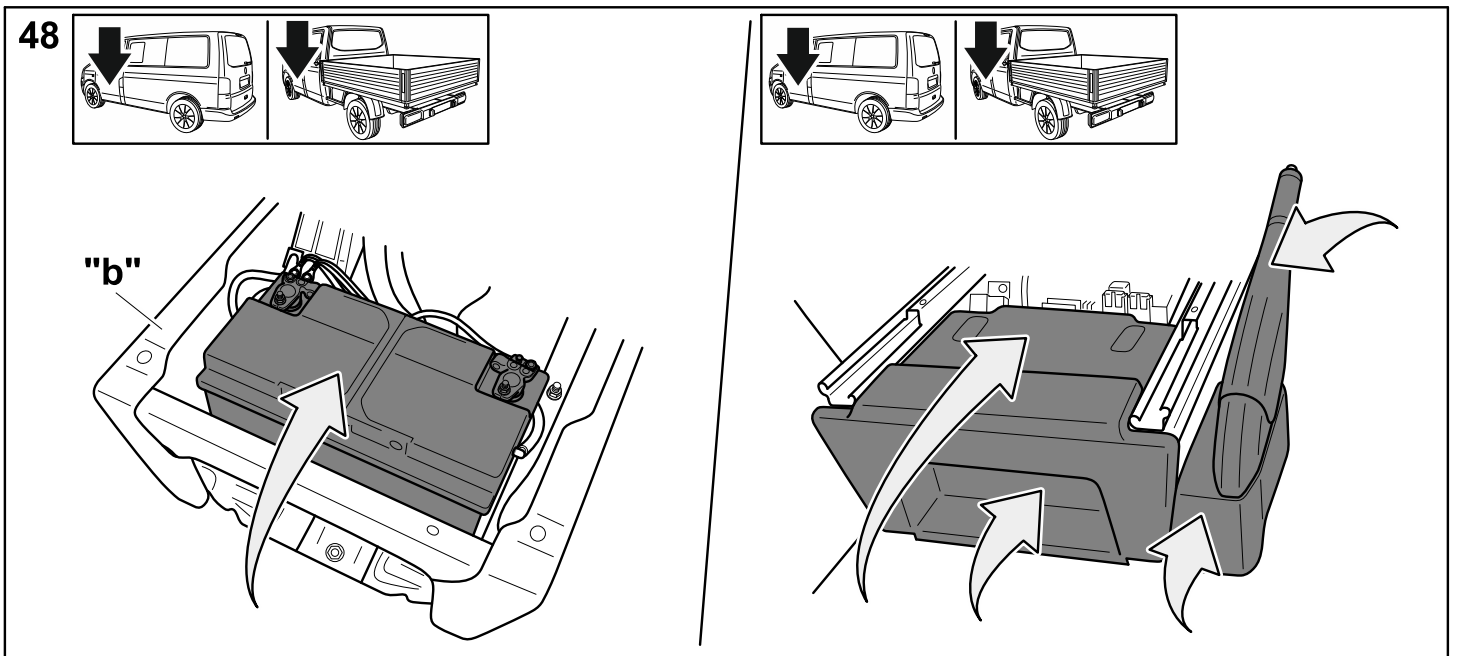
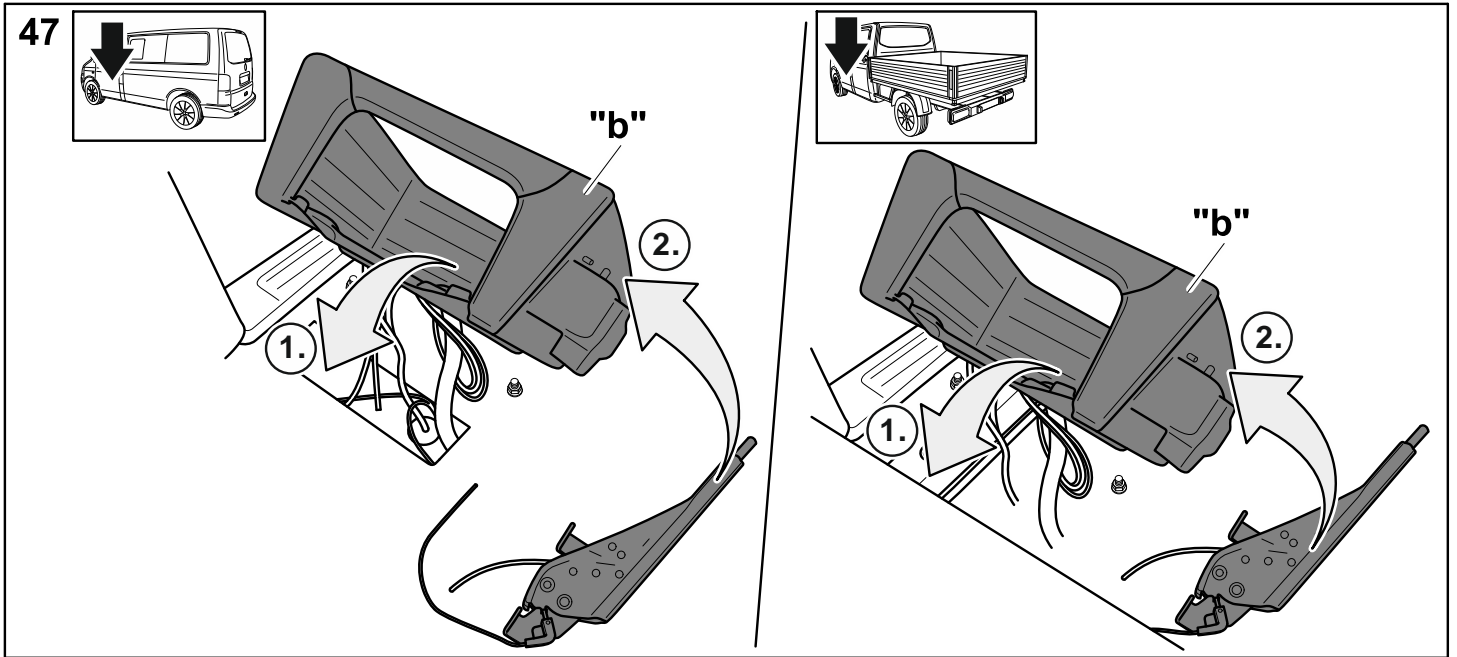

50

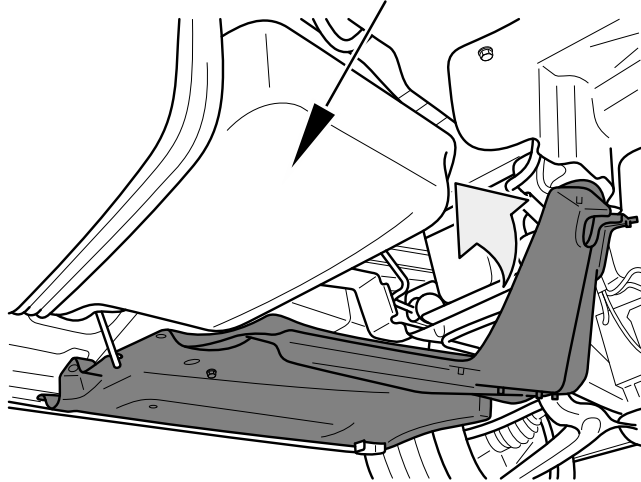
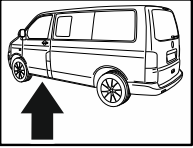

51

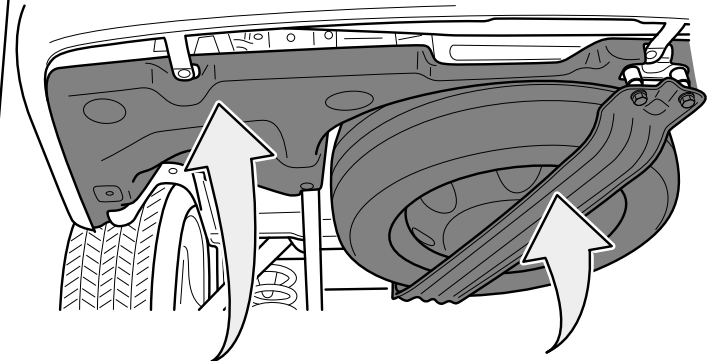
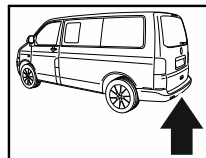
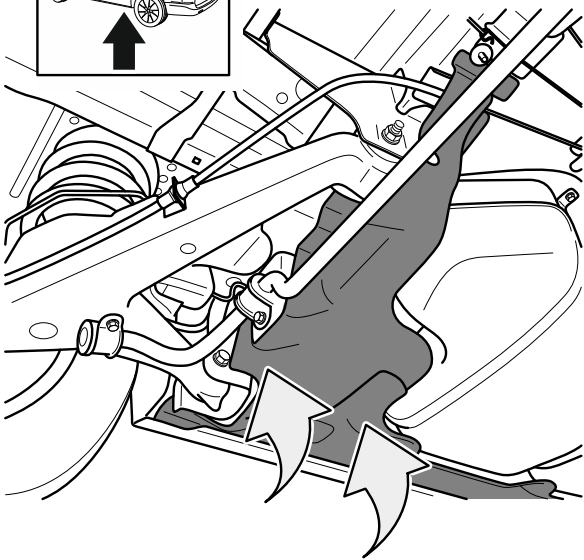
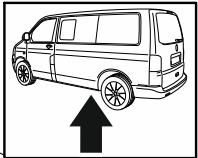

52

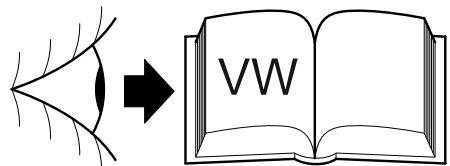
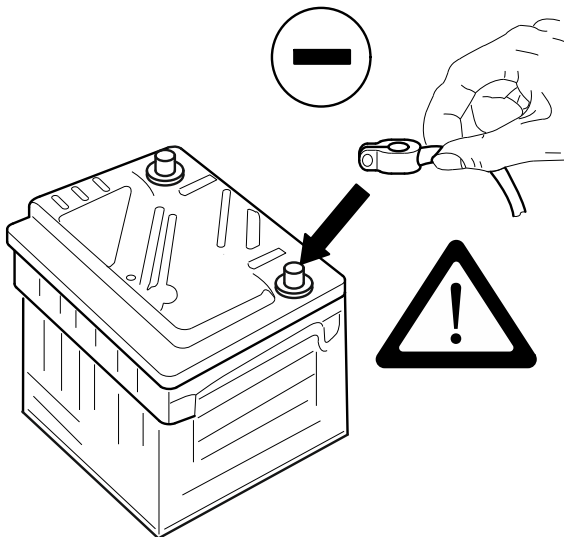

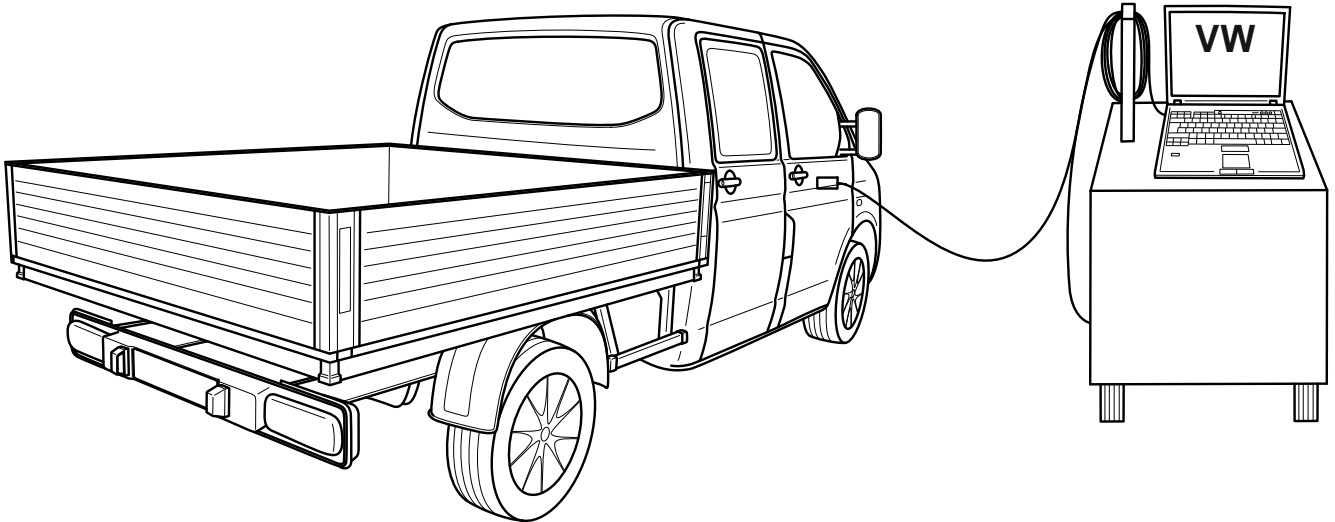
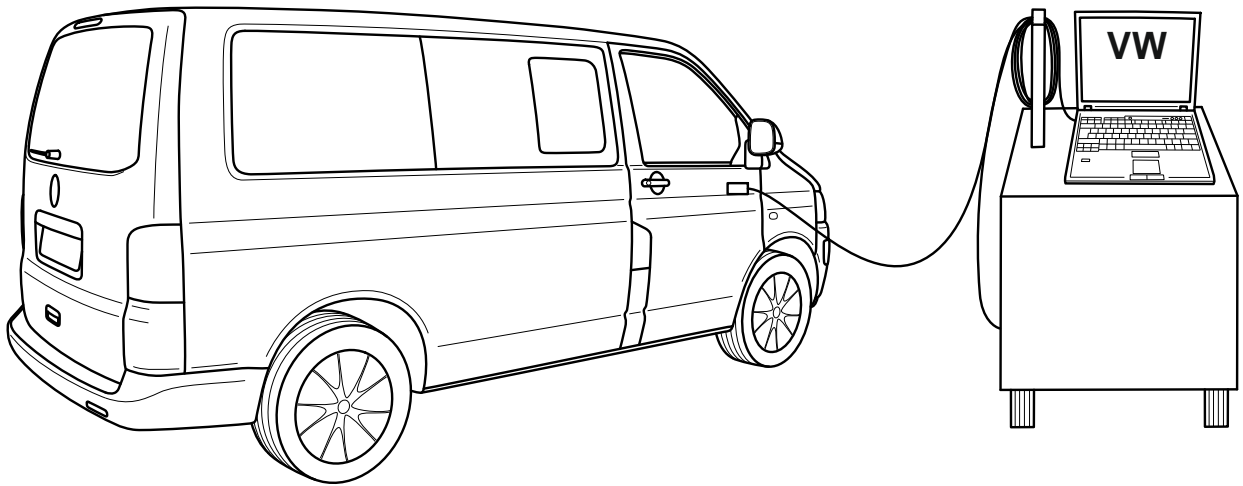

- GB**
1. The vehicle's gateway has to be coded as follows using a service tester to extend its functionality to the use of a towing hitch:
 - Address word "19", diagnosis interface for data bus.
 - Select function 008 coding (service \$22).
 - Select function 008.02 coding.
 - Select address word „69“, trailer function.
 - Change to „Coded“.
 - Continue the coding according to the menu.
 2. For vehicles fitted with parking assistance II or parking steering assistant, code the control unit using the VAS tester via "Guided trouble shooting" to "with a towing hitch".
 3. Finally, as at the beginning, perform a system request regarding the "Guided error location" and delete error codes if necessary.

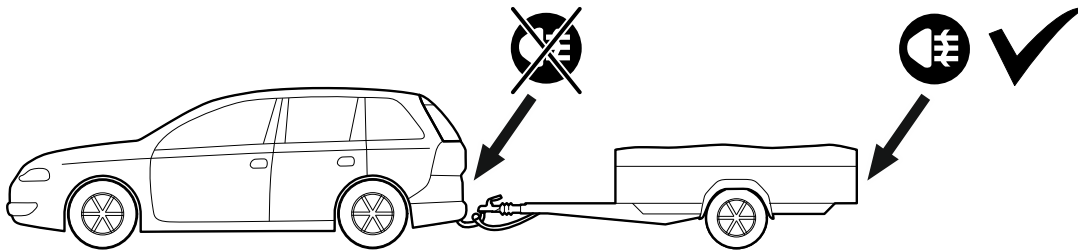

GB When towing a trailer, the rear fog light of the pulling vehicle is switched off.

LED  ✓ min. 50mA

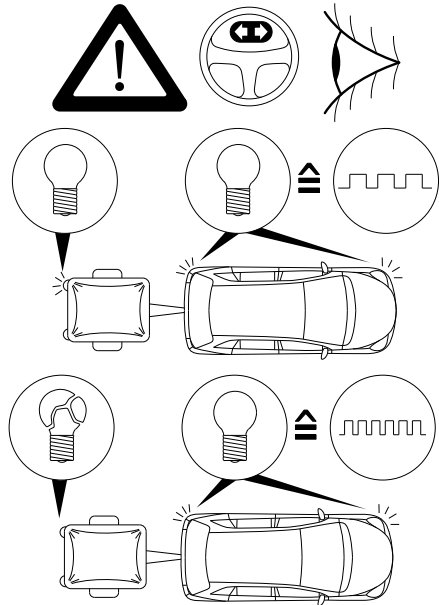
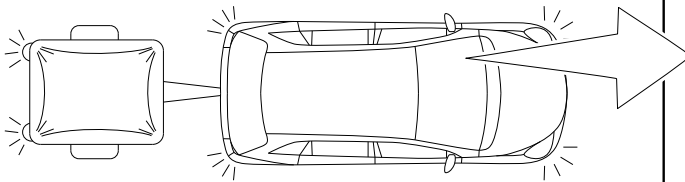
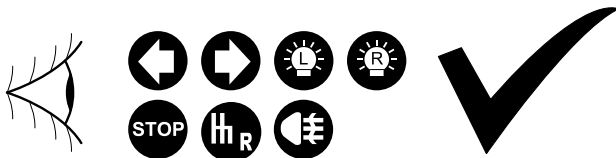

Trailer simulation
for light-check
7-pin and 13-pin
WA no.: 900 001 300 198

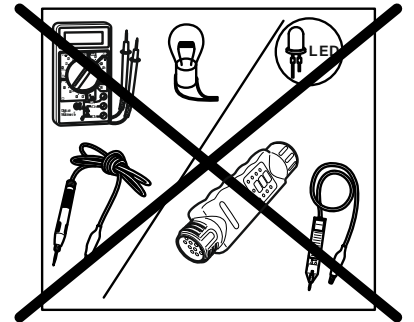
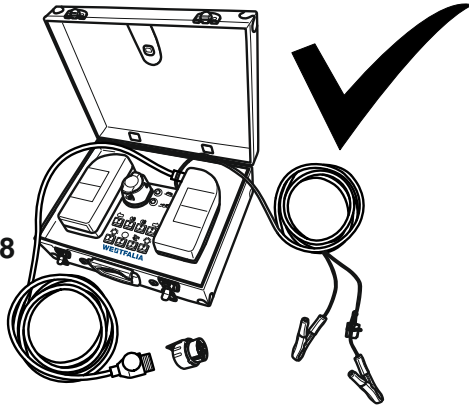

GB In case of functional problems, limit troubleshooting to about 30 minutes and then contact customer service.

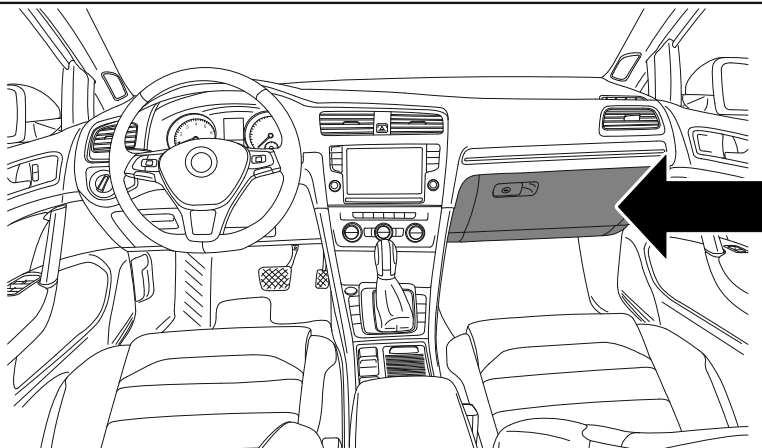

31

pin 10 $\begin{matrix} - & + & - \\ | & | & | \\ \oplus & \ominus & \oplus \end{matrix}$ +15

pin 11 $\begin{matrix} | \\ | \\ \ominus \end{matrix}$

3

pin 10 $\begin{matrix} - & + & - \\ | & | & | \\ \oplus & \ominus & \oplus \end{matrix}$ +15

westfalia
AUTOMOTIVE

WA no.: 300 028 300 113

**optional:
adapter socket**

westfalia
AUTOMOTIVE

13-pin 7-pin

WA no.: 300 100 320 113

**WA no.
900 001 506 387**

**WA no.
900 001 506 024**

**WA no.
900 001 506 758**

westfalia
AUTOMOTIVE

Westfalia Cycle Carrier
WA no.: 350 050 600 001

Box
WA no.: 350 002 600 001