

Notice de pose du faisceau électrique pour  
crochet d'attelage avec prise 13 voies

Version : 3/5 DOORS

Année : 09/2007 →

Réf : 173110

308



0 H 30

Einbauanleitung elektrosetz Anhängervorrichtung mit Steckdosen 13-Polig  
Fitting instructions electric wiringkit towbar with socket 13-pin  
Montage-handleiding elektrokabelset voor trekhaak met contactdoos 13-polig

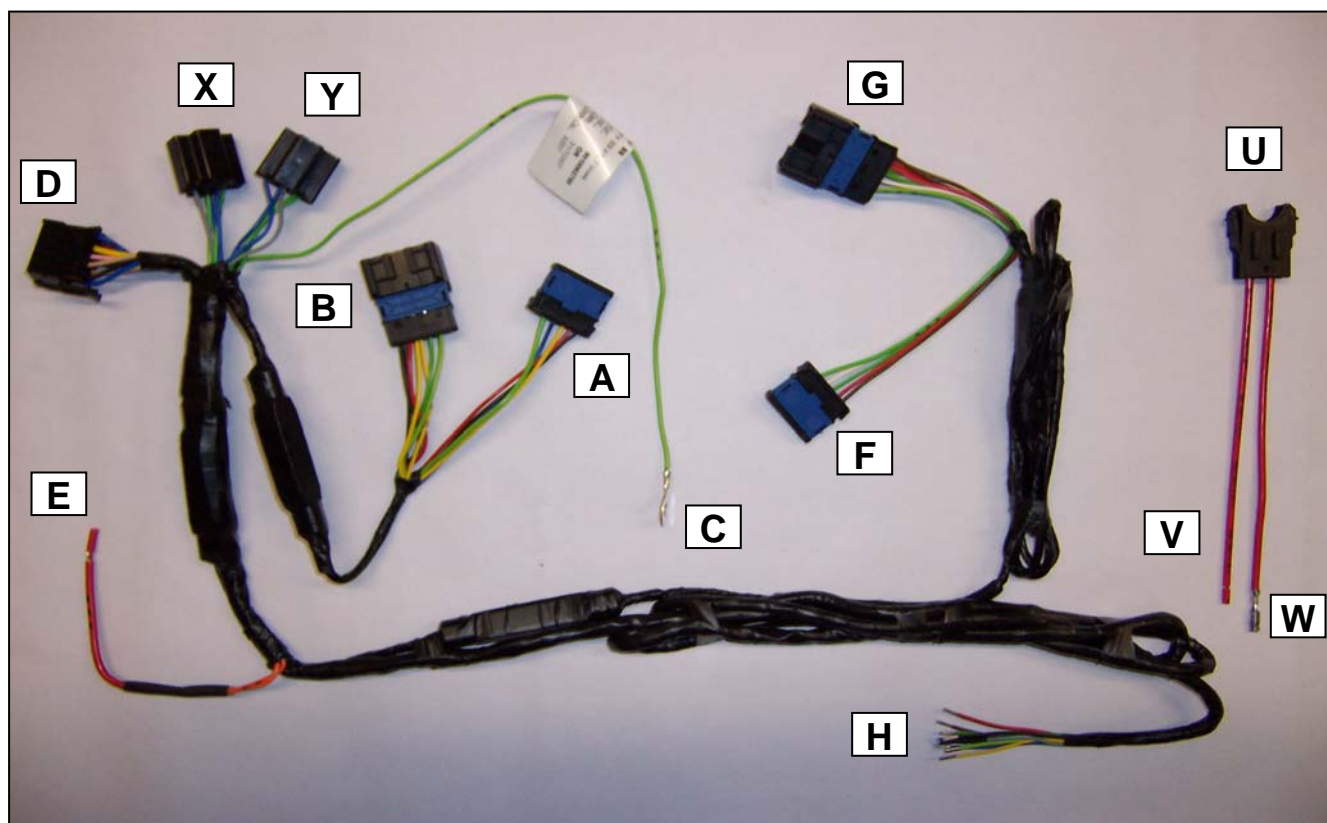
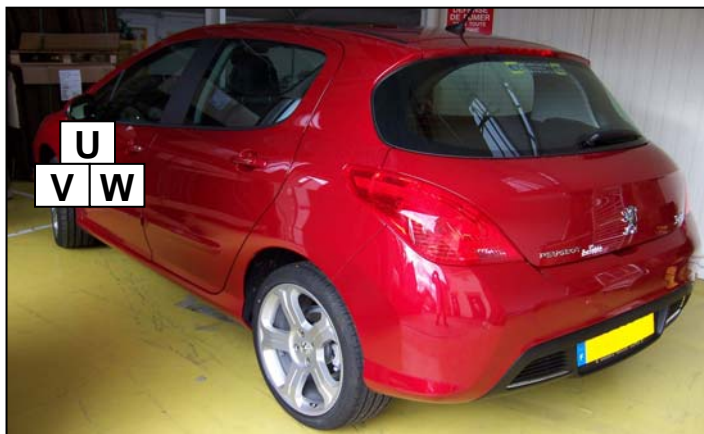

Liste des pièces / Teilliste / Part list / Onderdelenlijst :

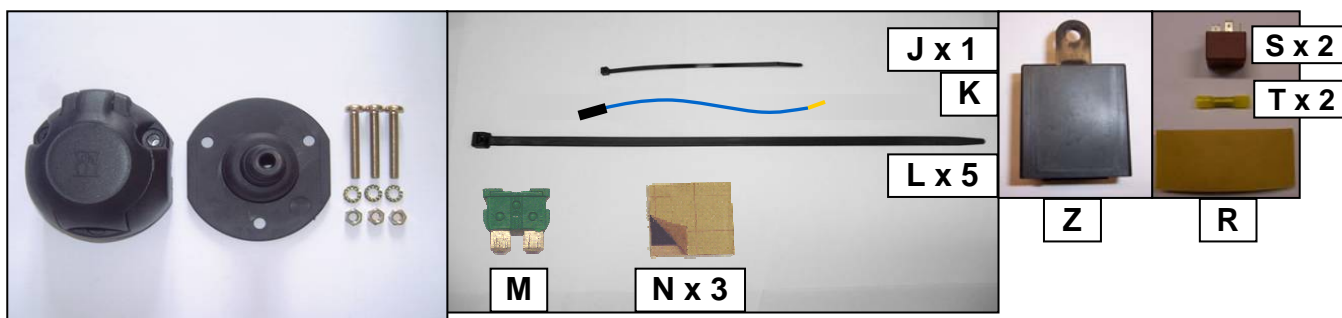

Cette notice ne peut être divulguée ou reproduite, partiellement ou en totalité, sans accord de la société.

1

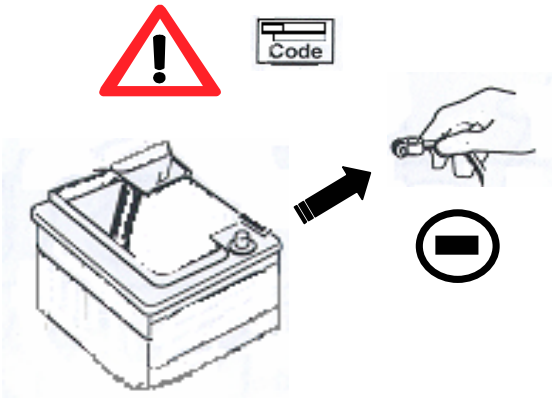

2



3



4



5

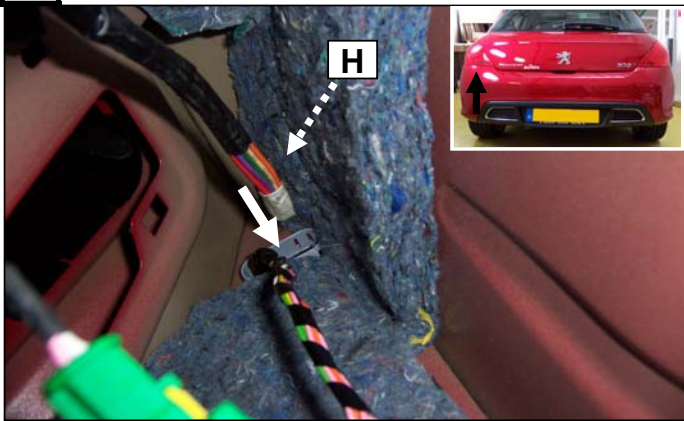

6

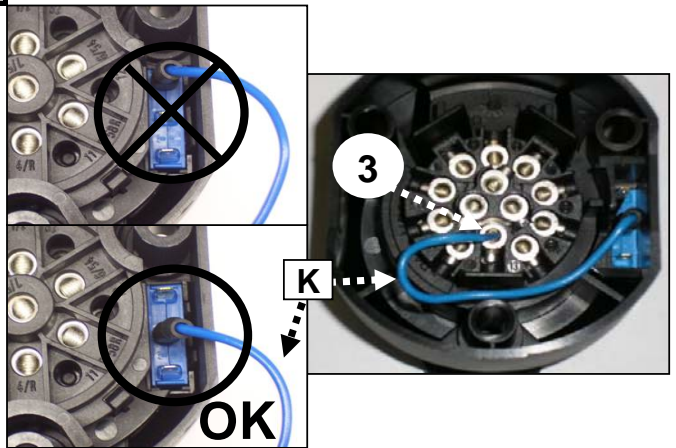

	1/L	2/54g	3/31	4/R	5/58R	6/54	7/58L	8	9	13	C
F	Jaune	Bleu	Vert/jaune	Vert	Marron	Rouge	Noir	Blanc	Orange	Vert/jaune	Gris
D	Gelb	Blau	Grün/gelb	Grün	Braun	Rot	Schwarz	Weiß	Apfelsine	Grün/gelb	Grau
GB	Yellow	Blue	Green/yellow	Green	Brown	Red	Black	White	Orange	Green/yellow	Grey
NL	Geel	Blauw	Groen/geel	Groen	Bruin	Rood	Zwart	Wit	Sinaasappel	Groen/geel	Grijs
P	Amarelo	Azul	Verde/amarelo	Verde	Castanho	Vermelho	Preto	Branco	Laranja	Verde/amarelo	Cinzentu
I	Giallo	Blu	Verde/giallo	Verde	Marrone	Rosso	Nero	Bianco	Arancia	Verde/giallo	Grigio
E	Amarillo	Azul	Verde/amarillo	Verde	Marron	Rojo	Negro	Blanco	Naranja	Verde/amarillo	Gris

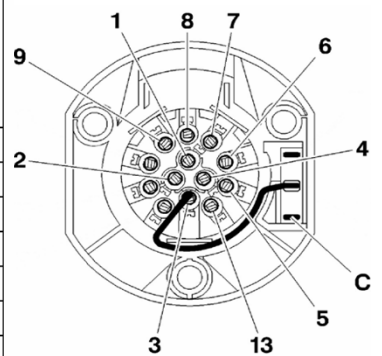

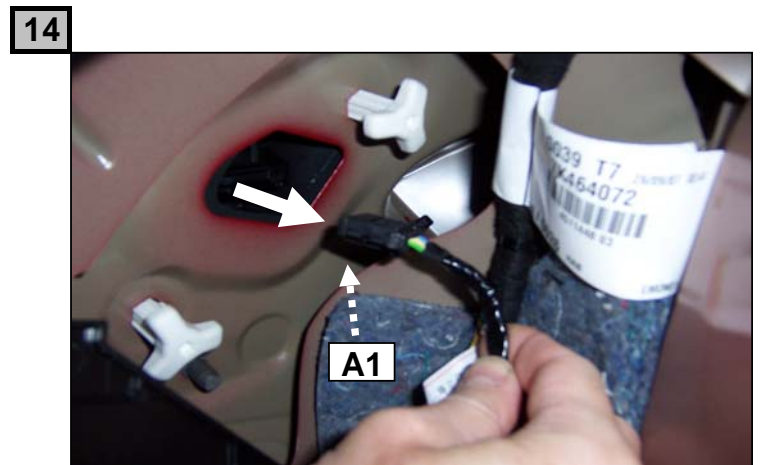
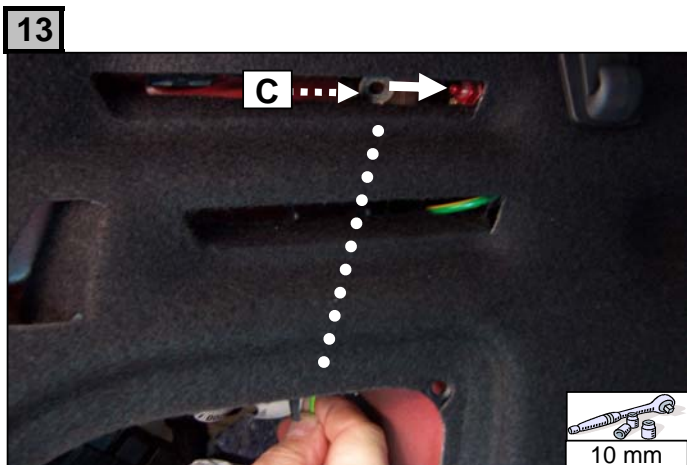
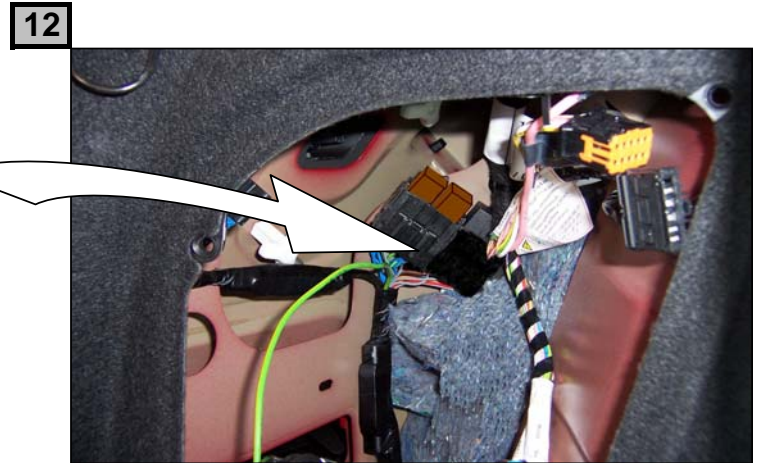
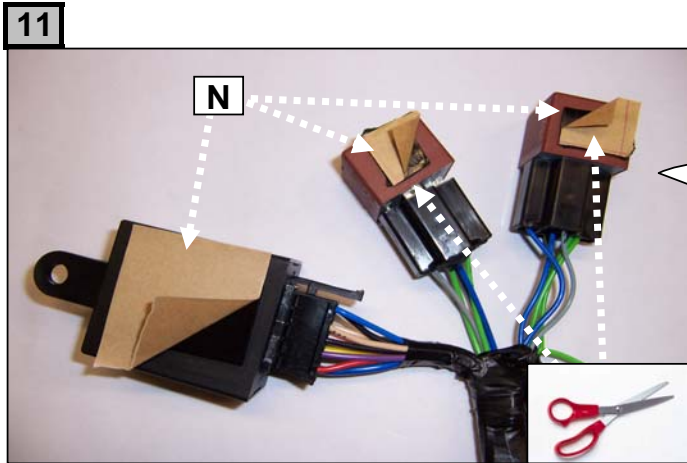
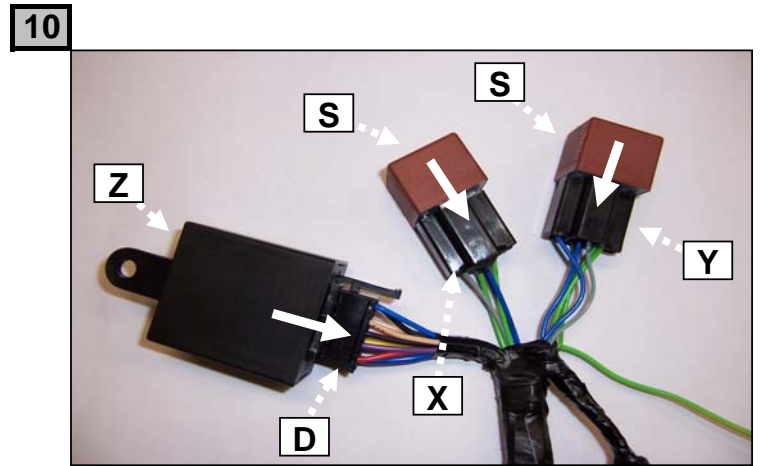
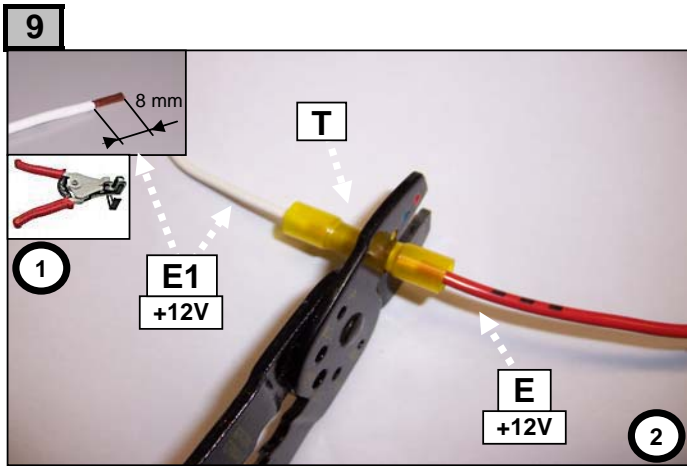
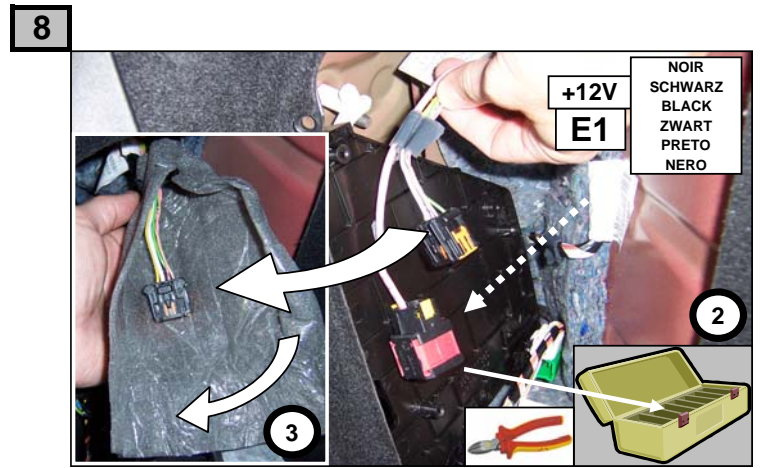

15

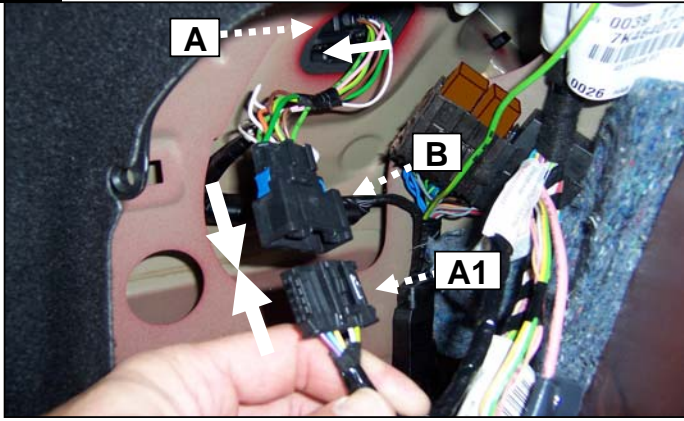

16

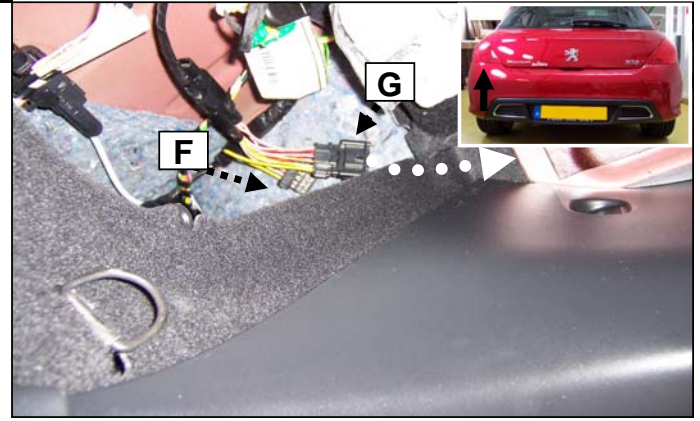

17

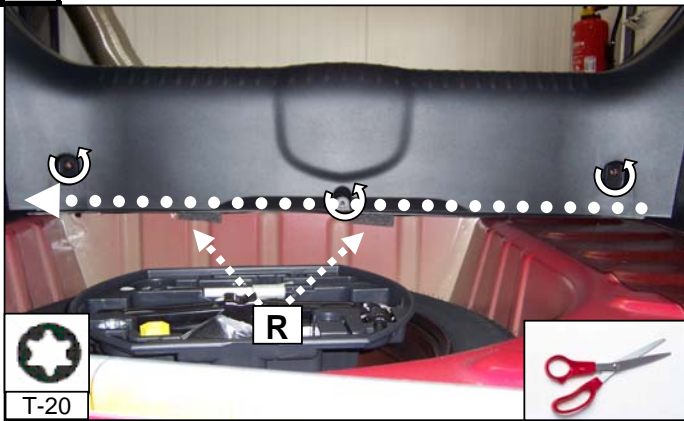

18

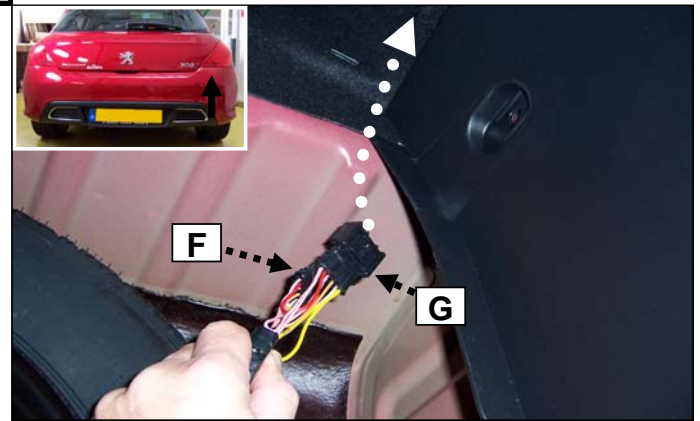

19

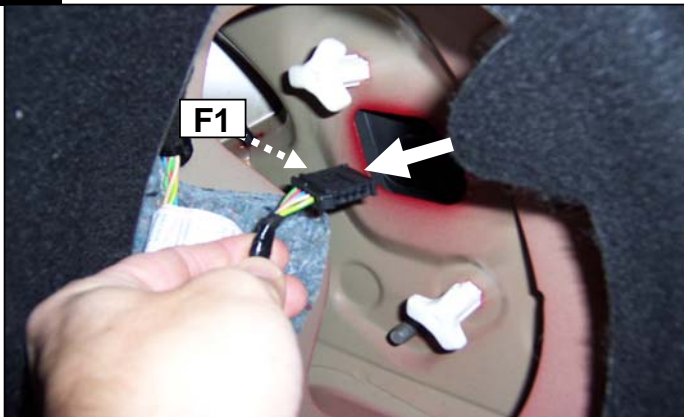

20

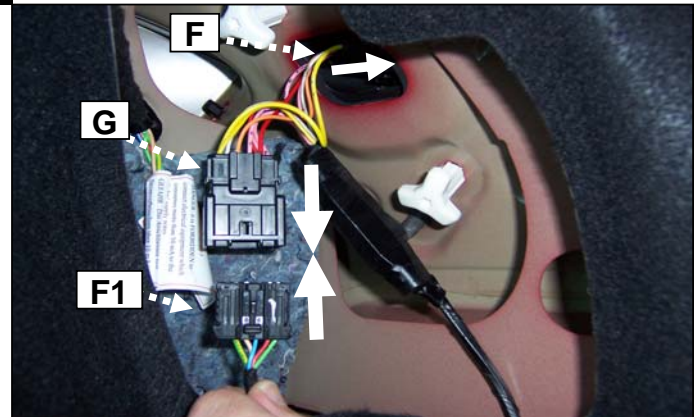

21



22

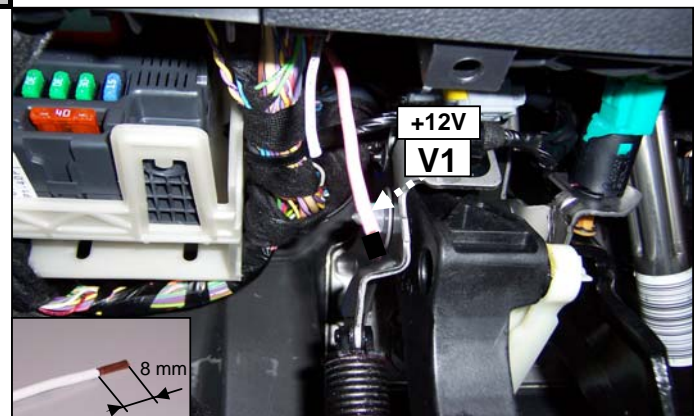

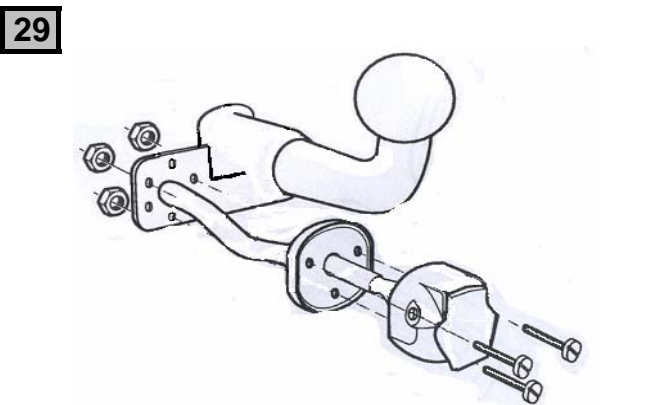
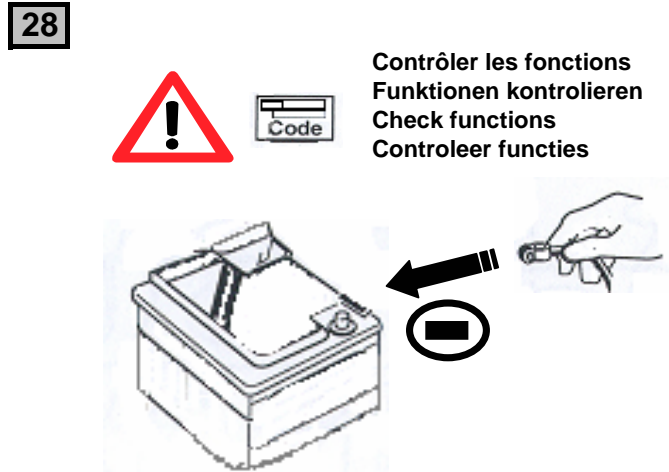
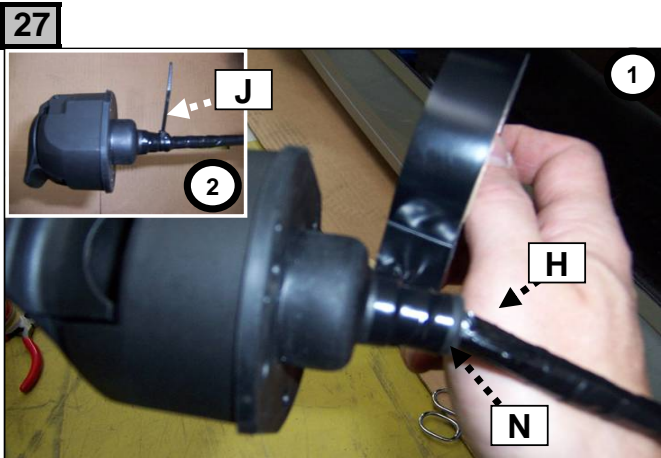
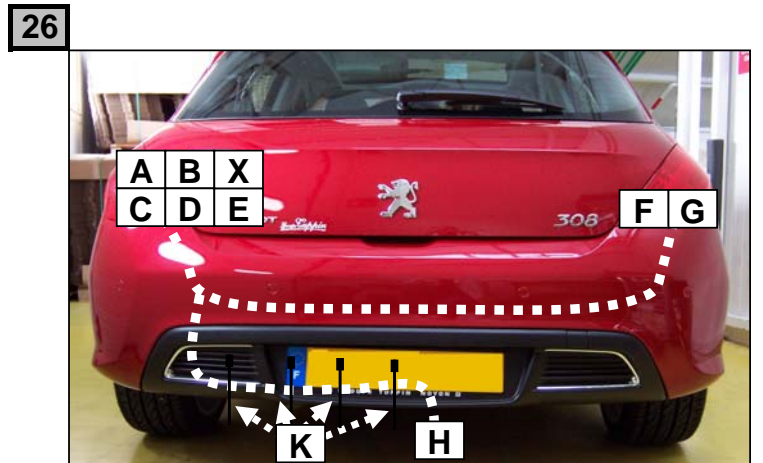
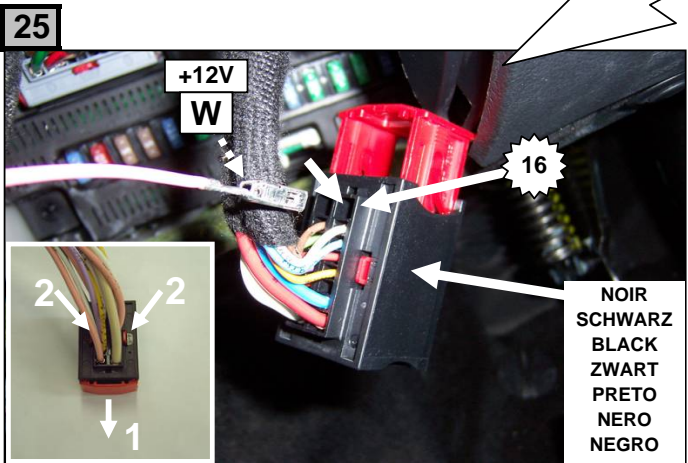
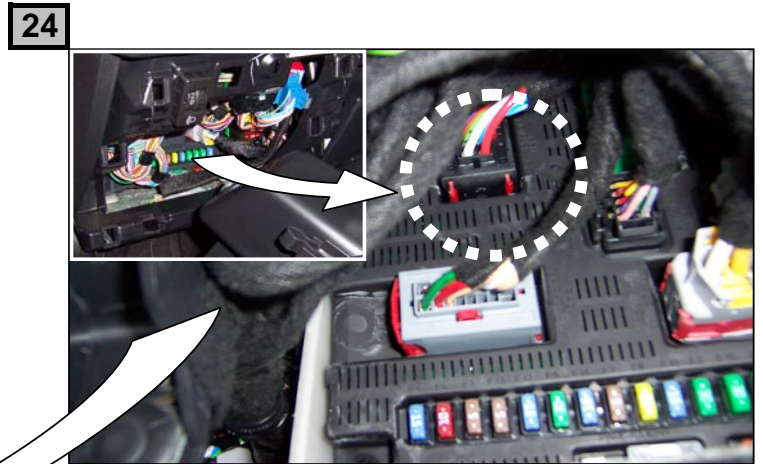
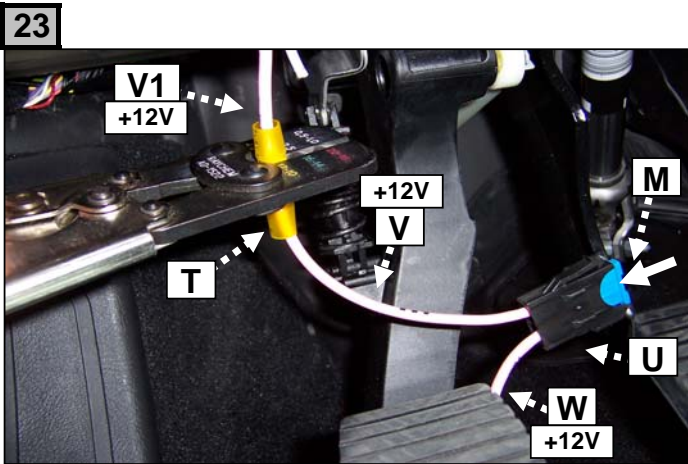

Lors du branchement de la remorque ,désactiver le système "RADAR DE RECU" au tableau de bord  
When you connect the trailer, do remove the function "PARK ASSIST" on the dashboard